

CITY OF PRINCE GEORGE
BYLAW NO. 9141, 2020

A Bylaw of the City of Prince George to permanently close a portion of lane located adjacent to 155 George Street and to remove its lane dedication for the purpose of future disposal of the lands.

WHEREAS the Council of the City of Prince George deems it desirable that an approximate 144.9 m² (square metre) of lane dedicated on Plan 1268, as shown on Reference Plan EPP104532, adjacent to Lot 1, Plan PGP44884, District Lot 343, Cariboo District, be closed to traffic, and that the lane dedication thereof be removed;

AND WHEREAS, in accordance with section 40 of the *Community Charter*, notice of intention to adopt this Bylaw has been delivered, posted and published, and an opportunity has been provided for persons who consider they are affected by this bylaw to make representations to Council;

NOW THEREFORE the Council of the City of Prince George, in open meeting assembled, **ENACTS AS FOLLOWS:**

1. That the portion of lane dedicated on Plan 1268, adjacent to the property legally described as Lot 1, Plan PGP44884, District Lot 343, Cariboo District as shown outlined in bold black on the Reference Plan EPP104532, attached hereto as Appendix "A" and forming part of this Bylaw, is closed to traffic.
2. That the portion of lane dedicated on Plan 1268, adjacent to the property legally described as Lot 1, Plan PGP44884, District Lot 343, Cariboo District as shown outlined in bold black on the Reference Plan EPP104532, attached hereto as Appendix "A" and forming part of this Bylaw, is removed.
3. The Mayor and Corporate Officer are hereby empowered to do all things necessary to give effect to this Bylaw.
4. This Bylaw shall come into full force and take effect upon its adoption and shall be filed with the Registrar of the applicable Land Title Office.
5. This Bylaw may be cited for all purposes as "City of Prince George 155 George Street Road Closure Bylaw No. 9141, 2020".

READ A FIRST TIME THIS **19TH** DAY OF **OCTOBER** , 2020.

READ A SECOND TIME THIS **19TH** DAY OF **OCTOBER** , 2020.

First two readings passed by
a
and eligible to vote.

UNANIMOUS decision of Members of City Council present

READ A THIRD TIME THIS **23RD** DAY OF **NOVEMBER** , 2020.

Third reading passed by a **UNANIMOUS** decision of Members of City Council present and eligible to vote.

Certified correct as passed third reading this **24TH** day of **NOVEMBER** , 2020.



CORPORATE OFFICER OF
THE CITY OF PRINCE GEORGE

APPROVED BY THE MINISTER OF TRANSPORTATION AND INFRASTRUCTURE PURSUANT TO THE PROVISIONS OF SECTION 41(3) OF THE COMMUNITY CHARTER.

THIS *26* DAY OF *November* 2020.



for MINISTER OF TRANSPORTATION
AND INFRASTRUCTURE

ADOPTED THIS DAY OF , 2020,

BY A DECISION OF ALL MEMBERS OF CITY COUNCIL PRESENT AND
ELIGIBLE TO VOTE.

MAYOR

CORPORATE OFFICER

PLAN EPP104532

THIS PLAN LIES WITHIN INTEGRATED SURVEY AREA
No. 39 PRINCE GEORGE, BC, NAD83 (CSRS) 4.0.0.BC.1

10 5 0 10 20 30 40

THE INTENDED PLOT SIZE OF THIS PLAN IS 560mm IN WIDTH BY 432mm IN HEIGHT (C SIZE) WHEN PLOTTED AT A SCALE OF 1:500.

ALL DISTANCES ARE IN METRES AND DECIMALS THEREOF.

GRID BEARINGS ARE DERIVED FROM OBSERVATIONS BETWEEN GEODETIC CONTROL MONUMENTS 85H1056 AND 85H1091.

THE UTM COORDINATES AND ESTIMATED ABSOLUTE ACCURACY ACHIEVED HAVE BEEN DERIVED FROM MASCOT PUBLISHED COORDINATES AND STANDARD DEVIATIONS FOR GEODETIC CONTROL MONUMENT 85H1081.

THIS PLAN SHOWS HORIZONTAL GROUND-LEVEL DISTANCES UNLESS OTHERWISE SPECIFIED. TO COMPUTE GRID DISTANCES, MULTIPLY GROUND-LEVEL DISTANCES BY THE AVERAGE COMBINED FACTOR OF 0.9995158 WHICH HAS BEEN DERIVED FROM GEODETIC CONTROL MONUMENTS 85H1091 AND 85H1056.

NOTE:
THIS PLAN SHOWS ONE OR MORE WITNESS POSTS
WHICH ARE NOT SET ON THE TRUE CORNER(S).
SOME POSTS AND LINES ARE EXAGGERATED FOR CLARITY.

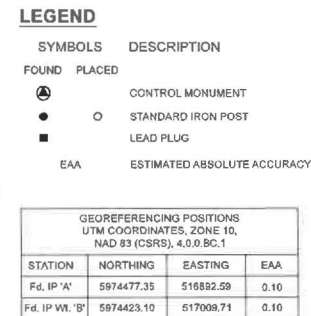

THE FIELD SURVEY REPRESENTED BY THIS PLAN WAS COMPLETED
ON THE 11th DAY OF AUGUST, 2020
SHAUNA C. GOERTZEN, BCLS 798

THIS PLAN LIES WITHIN THE REGIONAL DISTRICT OF FRASER-FORT GEORGE.