

First two readings passed by a **UNANIMOUS** decision of Members of City Council present and eligible to vote.

READ A THIRD TIME THIS **15TH** DAY OF **JUNE**, 2020.

Third reading passed by a **UNANIMOUS** decision of Members of City Council present and eligible to vote.

ADOPTED THIS DAY OF 2020,
BY A DECISION OF ALL MEMBERS OF CITY COUNCIL PRESENT AND
ELIGIBLE TO VOTE.

MAYOR

CORPORATE OFFICER

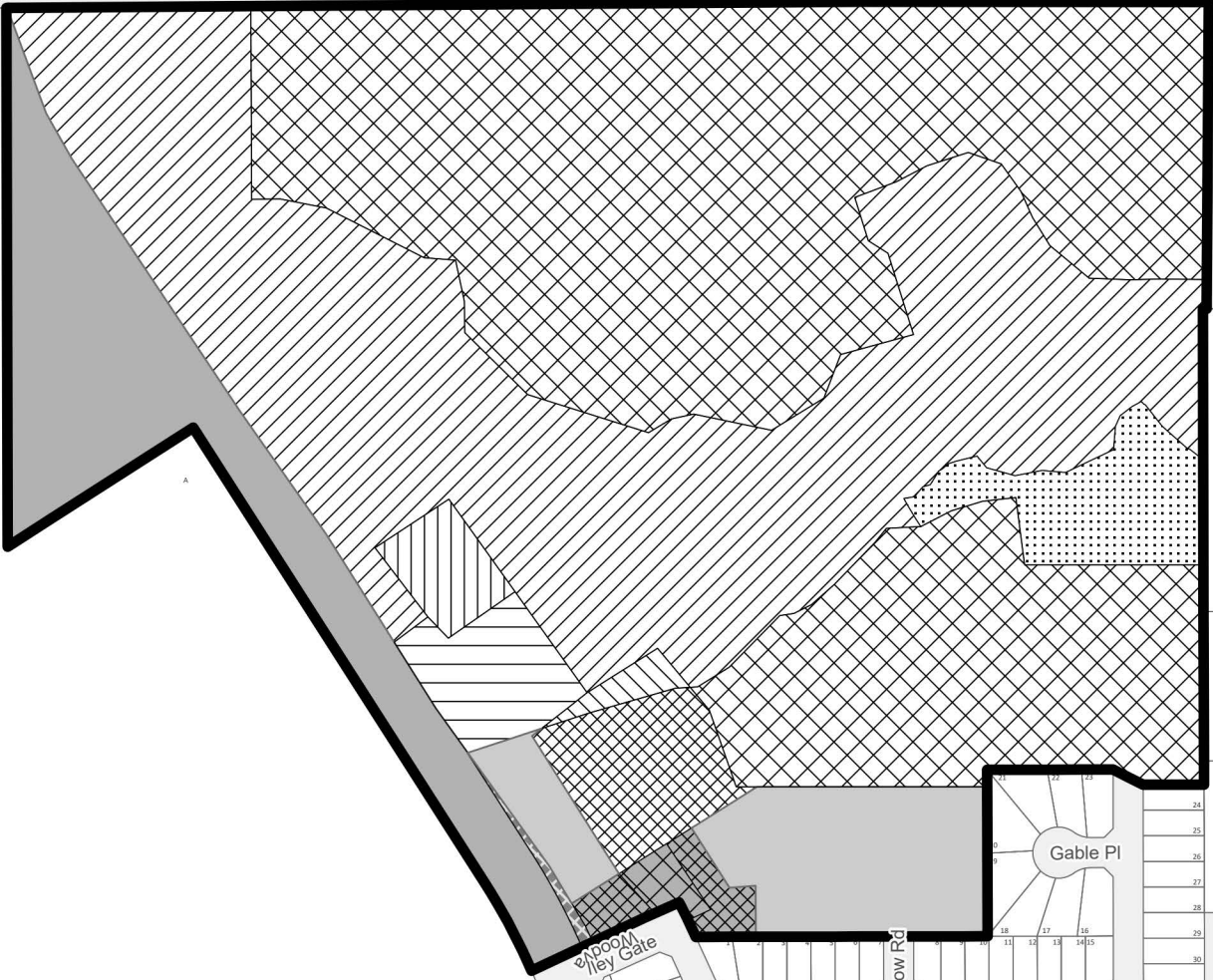
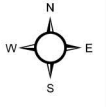

- Subject Parcel
- Rezone from AF: Agriculture & Forestry to P1: Parks and Recreation
- Rezone from AF: Agriculture & Forestry to AG: Greenbelt
- Rezone from P1: Parks and Recreation to AG: Greenbelt
- Rezone from RS1: Suburban Residential to AG: Greenbelt
- Rezone from RS2: Single Residential to AG: Greenbelt
- Rezone from AF: Agriculture & Forestry to RS2: Single Residential
- Rezone from P1: Parks and Recreation to RS2: Single Residential
- Rezone from RM1: Multiple Residential to RS2: Single Residential
- Rezone from RS1: Suburban Residential to RS2: Single Residential
- Rezone from AG: Greenbelt to RS2: Single Residential
- Remain RS2: Single Residential
- Remain AG: Greenbelt
- Parcel

0 50 100 200 300 400 Meters
 Coordinate System: NAD 1983 UTM Zone 10N
 Projection: Transverse Mercator
 Datum: North American 1983
 1:5,000

Appendix 'A' to Bylaw NO. 9119

South West ¼ of DL 2425 CD, Except Plans 29255, PGP37227, PGP40290, and EPP55596

