

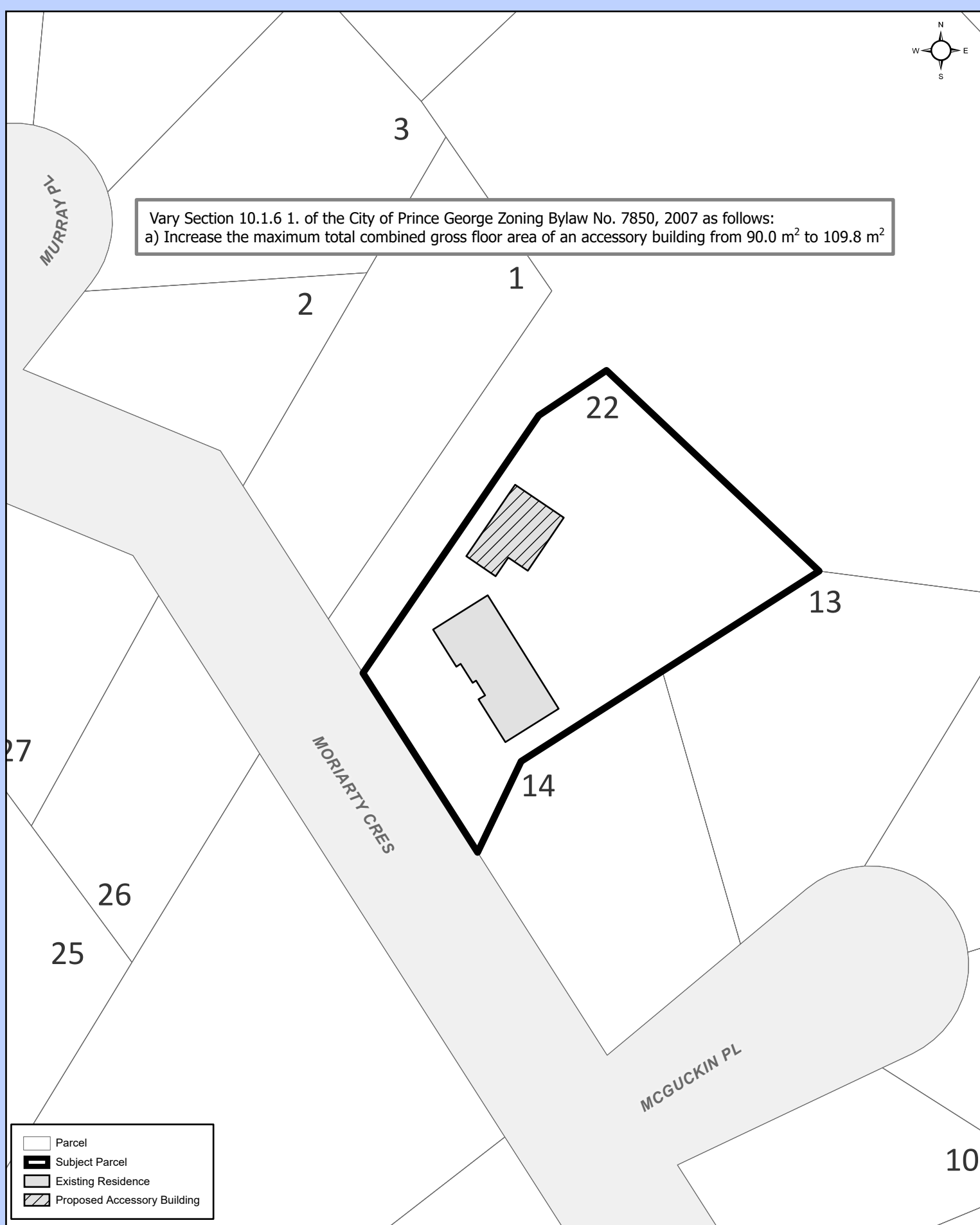

Vary Section 10.1.6 1. of the City of Prince George Zoning Bylaw No. 7850, 2007 as follows:
a) Increase the maximum total combined gross floor area of an accessory building from 90.0 m² to 109.8 m²



- Parcel
- Subject Parcel
- Existing Residence
- Proposed Accessory Building

0 50 100 200 300 400 Meters
Coordinate System: NAD 1983 UTM Zone 10N
Projection: Transverse Mercator
Datum: North American 1983
1:750

Exhibit "A" to VP100564
Lot 22, DL 753, CD, Plan 22474

 **CITY OF PRINCE GEORGE**