

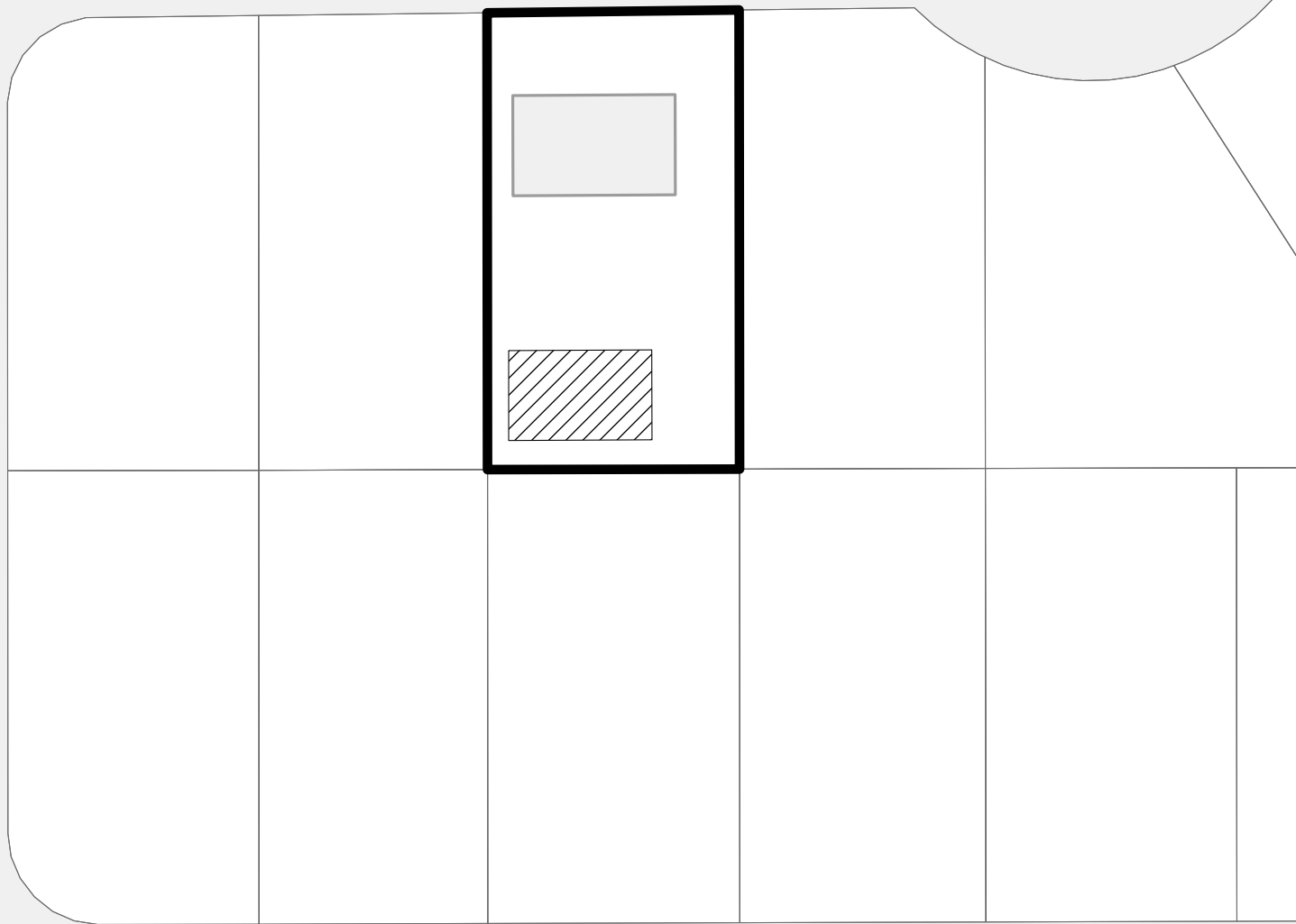

Vary Section of 5.6.6 of City of Prince George Zoning Bylaw No. 7850, 2007 as follows:  
a) Increase the maximum floor area of a secondary dwelling from 40% to 60% of the total floor area of the principal dwelling.

MICHENER CRES



	Existing House
	Proposed Carriage House
	Subject Parcel
	Parcel

PINEWOOD AVE

0 50 100 200 300 400 Meters  
Coordinate System: NAD 1983 UTM Zone 10N  
Projection: Transverse Mercator  
Datum: North American 1983  
1:500

**Exhibit "A" to VP100567**  
Lot 10, DL 8175, CD, Plan 17631

