

3

22

To vary section 10.1.6 1. of the City of Prince George Zoning Bylaw No. 7850, 2007 by increasing the maximum combined gross floor area of accessory buildings and structures on a site from 90.0 m² to 186.0 m².

21

PCL A

Hillcrest Pl

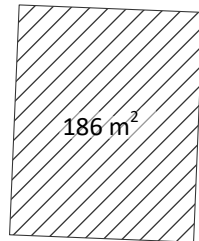





PCL B

17

A

16

-  Subject Parcel
-  Existing Residence
-  Proposed Accessory Building
-  Parcel

0 10 20 30 Meters

Coordinate System: NAD 1983 UTM Zone 10N
Projection: Transverse Mercator
Datum: North American 1983

1:500

Exhibit "A" to VP100671
Lot A, DL 2003, CD, Plan PGP38074

