

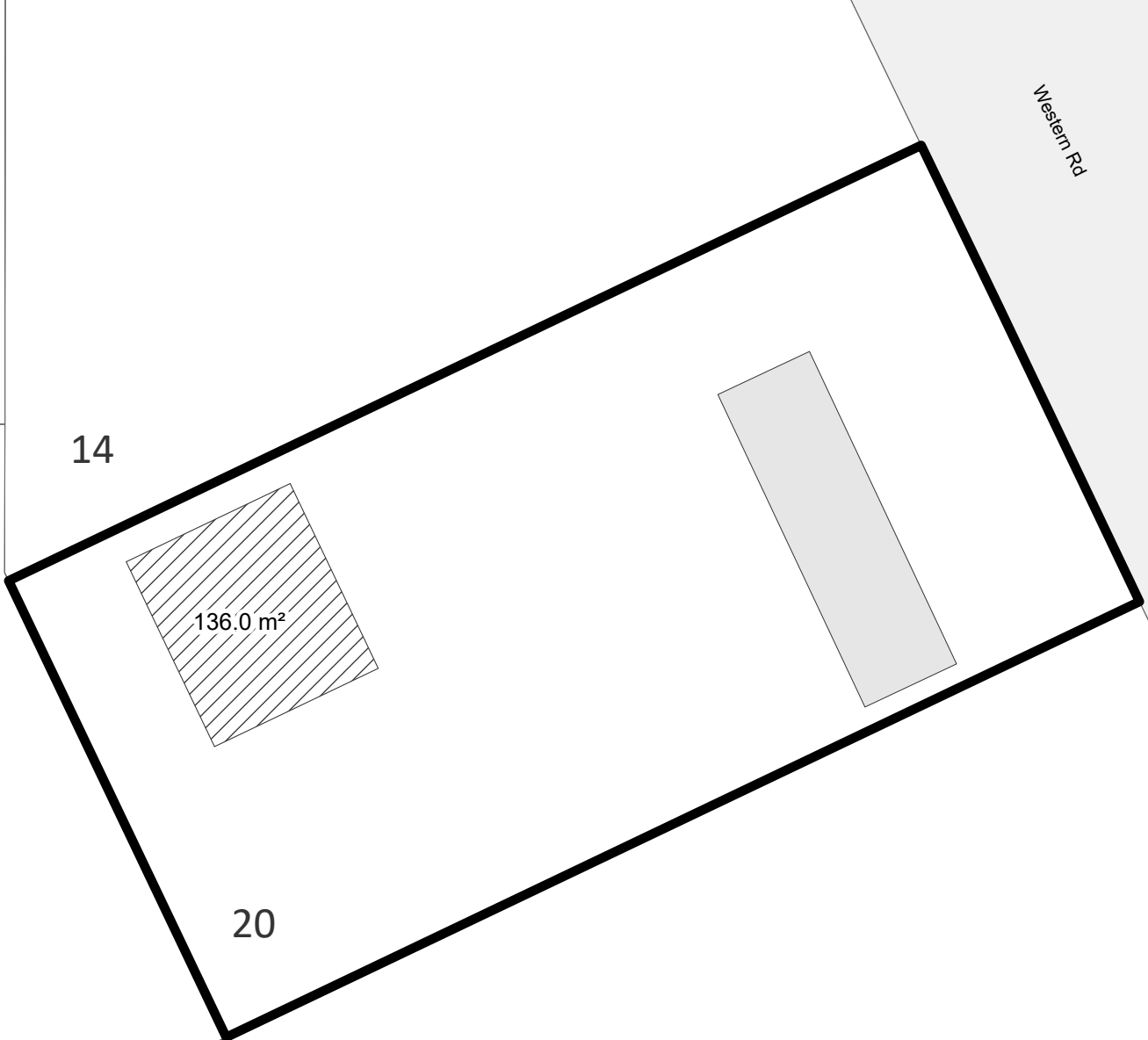



Vary Section 10.1.6 1. of the City of Prince George Zoning Bylaw No. 7850, 2007 to increase the total maximum combined gross floor area of accessory buildings and structures on a site from 90.0 m<sup>2</sup> to 136.0 m<sup>2</sup>.



-  Subject Parcel
-  Existing Residence
-  Proposed Accessory Building
-  Parcel

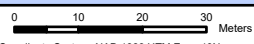

Coordinate System: NAD 1983 UTM Zone 10N  
Projection: Transverse Mercator  
Datum: North American 1983

1:400

**Exhibit "A" to VP100651**  
Lot 20, DL 625, CD, Plan 13646

