

DATE: 2023-07-26 16:54 FILE: \\2311337-01_CoP_Foothills-18th-Roundabout\110_Drawing\101_Signage & Pavement Markings.dwg

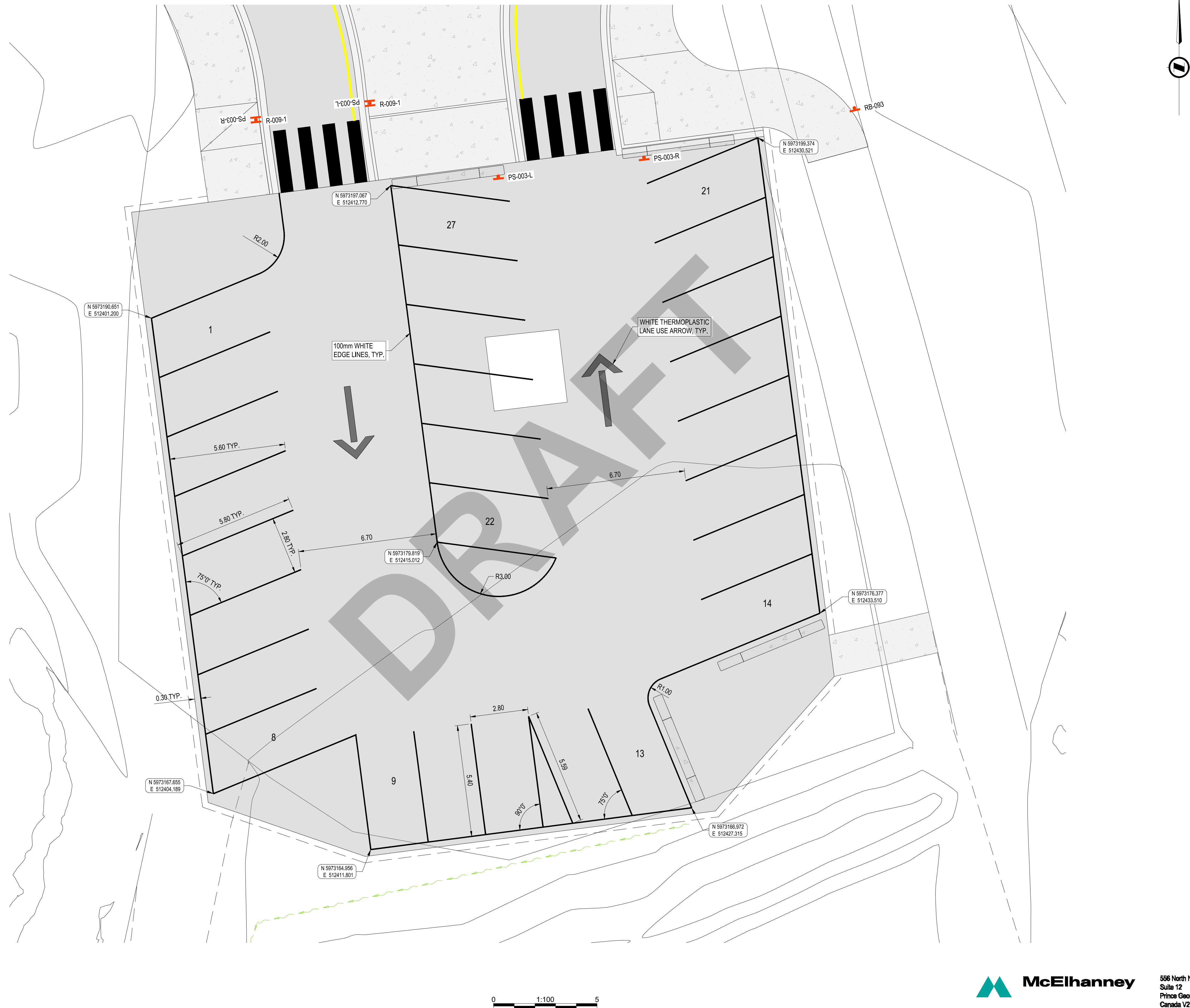

Legend

- JUNCTION BOX
- LIGHT STANDARD
- HYDRANT
- WATER VALVE
- STORM MANHOLE
- CATCH BASIN - SINGLE
- CATCH BASIN - DOUBLE
- SEWER MANHOLE
- SIGN

- CURB
- SIDEWALK
- STORM MAIN
- SEWER MAIN
- WATER MAIN
- IRRIGATION
- LITE LINE - UNDERGROUND
- POWER - OVERHEAD
- POWER - UNDERGROUND
- PAINT LINE - BROKEN
- PAINT LINE - BROKEN
- PAINT LINE - BROKEN
- PAINT LINE - CONTINUOUS

No.	DATE	REVISION	DR
0	23-07-21	PARKING ADDITION	DMW

CITY OF PRINCE GEORGE
Engineering Services

DRAWN: D. WENTLAND
 CHECKED: J. TAKER
 ENGINEER: I. McCALL
 SURVEY FILE: 21337-01 V-MODL
 DRAWING FILE: SIGNAGE & PAVEMENT MAR
 CORRESPONDENCE: CoPG
 GRID: UTM ZONE 10 NAD 83
 DATE: July 25, 2023
 HORZ. 100 SCALES: VERT. N/A

FOOTHILLS/ 18TH ROUNDABOUT
 SIGNAGE AND PAVEMENT MARKINGS

PROJECT No.
2341-21337-01
 DRAWING No.
C203

SHEET No. 9 of 20 REV. No. 0

THIS DRAWING AND DESIGN IS THE PROPERTY OF THE CITY OF PRINCE GEORGE AND SHALL NOT BE USED, REUSED OR REPRODUCED WITHOUT THE CONSENT OF THE CITY OF PRINCE GEORGE. THE CITY OF PRINCE GEORGE AND McELHANNEY WILL NOT BE HELD RESPONSIBLE FOR THE IMPROPER OR UNAUTHORIZED USE OF THIS DRAWING AND DESIGN.

THIS DRAWING AND DESIGN HAS BEEN PREPARED FOR THE CLIENT IDENTIFIED. TO MEET THE STANDARDS AND REQUIREMENTS OF THE APPLICABLE PUBLIC AGENCIES AT THE TIME OF PREPARATION. McELHANNEY, ITS EMPLOYEES, SUBCONSULTANTS AND AGENTS WILL NOT BE LIABLE FOR ANY LOSSES OR OTHER CONSEQUENCES RESULTING FROM THE USE OR RELIANCE UPON, OR ANY CHANGES MADE TO, THIS DRAWING, BY ANY THIRD PARTY, INCLUDING CONTRACTORS, SUPPLIERS, CONSULTANTS AND STAKEHOLDERS, OR THEIR EMPLOYEES OR AGENTS, WITHOUT McELHANNEY'S PRIOR WRITTEN CONSENT.

INFORMATION ON EXISTING UNDERGROUND FACILITIES MAY NOT BE COMPLETE OR ACCURATE. McELHANNEY, ITS EMPLOYEES AND DIRECTORS ARE NOT RESPONSIBLE NOR LIABLE FOR THE LOCATION OF ANY UNDERGROUND CONDUITS, PIPES, CABLES OR OTHER FACILITIES WHETHER SHOWN OR OMITTED FROM THIS PLAN. PRIOR TO CONSTRUCTION CONTRACTOR SHALL EXPOSE LOCATIONS OF ALL EXISTING FACILITIES BY HAND DIGGING OR HYDRO/VAC AND ADVISE THE ENGINEER OF POTENTIAL CONFLICTS.

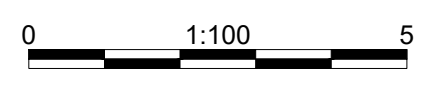

McElhanney
 556 North Nechako Road
 Suite 12
 Prince George BC
 Canada V2K 1A1
 Tel 250 561 2229