



REAPS

RECYCLING & ENVIRONMENTAL
ACTION PLANNING SOCIETY



Growing Knowledge Community Compost Garden

REAPS
Request for Funds
May 31, 2023

REAPS

The Recycling and Environmental Action Planning Society (REAPS) was incorporated as a society in 1990. Its main purpose is to facilitate awareness of human impacts on the environment and to take positive and practical action to reduce the pressures on the Earth's resources. Our vision and mission statements reflect our commitment to the environment and our region in which we serve to be an environmental educational resource.

Vision Statement

A waste free Northern BC.

Mission Statement

We support waste management solutions. We provide an environmental focus through workshops and presentations that encourages purposeful learning, and opportunities to develop as leaders, stewards and responsible citizens to participate in creating and maintaining healthy environments at home, school and in their community throughout the Regional District of Fraser Fort George. Respecting the beautiful unceded ancestral lands, culture, and people of the Lheidli T'enneh, McLeod Lake Indian Band, and Simpcw First Nation.

REAPS is committed to providing an inclusive, accessible, and safe environment where everyone can learn and thrive. We seek to ensure that our activities respect the needs and identities of all students, staff, faculty and community partners, with special attention to those historically underrepresented in our field. Equitable engagement in education is not only our responsibility, it enhances all facets of our work. The wisdom, expertise, and experiences brought by members from diverse groups are crucial components of environmental thought and action, inspiring innovative and impactful teaching and strengthening engagement across local and regional communities. We are committed to making continual improvements which increase diversity in all aspects of our society.

REAPS is currently an active member of Everyone at the Table; David Douglas Botanical Garden Society; Recycling Council of Alberta; Volunteer Prince George; Recycling Council of BC; Prince George Field Naturalist, Spruce City Wildlife Association; Canadian Network for Ocean Education Society; Columbia Basin Environmental Education Network; and Northern BC Climate Action Network.

Through these many initiatives, REAPS has been successful in fostering an awareness of waste management issues and encouraging environmental stewardship. With the support of local businesses, governments and volunteers who believe in this cause, the Society reaches further and further into the community each year. Funding for programs such as the Compost Demonstration Garden and outreach programs, increases the knowledge and resources of the community to secure a healthier future.

We acknowledge those who donate time and funding to this worthy cause. Thank you.

Executive Summary

REAPS, established in 1989, in partnership with the Regional District of Fraser-Fort George (RDFFG), provides direct and indirect services to reduce, reuse and recycle the solid waste stream in the Region. It also provides extensive educational and promotional services to that end.

REAPS provides direct services through collection and composting of organic waste from local businesses. It also provides support and promotion for other organizations in the redirection and recycling of solid waste. REAPS' primary business, however, is in providing direct promotional and educational services. Although much of this work is done in schools, REAPS also provides many educational services directly to the public. It also maintains a presence in any and all community activities which provide a forum for its '*reduce, reuse, recycle*' message. Its thirty-four years of work in the region have built a solid reputation in the communities that it serves.

REAPS continues to be aligned with the City of Prince George's strategic plan and on their sustainability pillars on environmental leadership and climate action. While REAPS is based in Prince George it continues to prioritize program delivery opportunities, and engagement and outreach in all communities within the RDFFG.

The City of Prince George has contributed to REAPS' work through infrastructure support of its programs by providing land on which the Compost Demonstration was built in 1994, and assisting with utility services to the site. REAPS appreciates and acknowledges the importance of those essential contributions to its programs. The City of Prince George in return has received the benefits of REAPS services to its residents through education, support of annual City Wide Clean Up, assistance with Bylaws Services regarding residential complaints on composting, fielding recycling questions from the service centre, providing on the ground eyes to the City's Parks Yard security, and supporting City initiatives around the environment, climate, and water.

REAPS unfortunately was not brought into the conversation between the Lheidli T'enneh First Nation (LTFN) and the City of Prince George when the future of our site was being discussed. To be clear, REAPS has no issue with the land transfer and fully supports the LTFN daycare project on the property.

Despite these stresses and surprises, we and our community supporters are optimistically building for the future so that we can continue to help our City and Region address existing and new environmental stewardship challenges. Through relocation and rebuilding of our educational and demonstration facility at the expanded botanical garden project, currently under construction at the University of Northern British Columbia, in partnership with the David Douglas Botanical Garden Society, we will have a new home from which to deliver and enhance our services.

To that end, REAPS is requesting that the City contribute in-kind and/or monetary assistance in the total value of \$100,000 to the initial works needed to make our project a reality. The specific services needed at this stage consist of final grading and top-dressing of the site and connection of the relocated garden office building to utilities (electrical and water) and installation of four water standpipes. The City's support for this initial phase would enable completion of the critical steps needed before the overall project can be completed, with estimated total costs of \$463,331.

Introduction

Society provides educational and practical resources to assist in reducing human impact on the environment. It works in schools and in communities, it serves to reduce the human footprint and to enhance the local environment.

This proposal incorporates REAPS' vision for its Growing Knowledge Community Compost Garden and of its Waste Reduction Education Programs. Included within this proposal is the background information on the Society's future compost demonstration site; its community outreach; its objectives for operational, educational and promotional programs related to waste reduction; and preliminary cost estimates for the Garden project. The purpose of this request is to continue the partnership with the goal of initiating the building of the Growing Knowledge Community Compost Garden beginning in June 2023.

Society Profile

The Recycling and Environmental Planning Society (REAPS) is a non-profit society (Incorporation Number S-0026137) and a registered charity (Charity Registration Number 889901195RR000) incorporated in British Columbia May 1, 1990. Its environmental solid waste education programs serve the region of Fraser-Fort George. Its mandate is to reduce the environmental impacts of waste primarily through education. REAPS has provided services to the region for all its 34 years.

The purposes of the Society are:

- 1) To educate the public on effective waste management practices by offering educational workshops, programs and presentations on this topic;
- 2) To educate and increase the public understanding of effective waste management and the environment by collecting and disseminating information on these topics; and
- 3) To provide and maintain an information hotline on waste management for the benefit of the community.

REAPS objectives include:

- 1) designing new and implementing existing programs, projects, campaigns and educational initiatives that will enhance the quality of our environment.
- 2) acting as a Resource Centre for information on alternatives to environmentally wasteful and /or damaging practices and products.
- 3) Supporting the Regional District of Fraser-Fort George (RDFFG) Solid Waste Management Plan

REAPS' reputation as an educational and resource organization has grown over its 34 years. Demands for its services have pushed it to reach further into the region. REAPS has met these demands with educational workshops and brochures such as: backyard composting, vermicomposting, organic gardening, natural pest control methods, recycling solutions, water conservation and alternative lawn maintenance. All of REAPS' programs deal with the responsibility for and consequences of a 'disposable' lifestyle. REAPS believes that practical education is the key to enhancing the environment. From kindergarten children to university students, from people at work to community organizations, REAPS has earned a notable public profile throughout the region, the province and the country. REAPS' education programs have been recognized locally and provincially.

Program Team

REAPS delivers its programs through staff resources with direction from a Board of Directors which is elected annually at the society AGM. The following roles are currently part of REAPS:

Table 1. REAPS Board of Directors

Board of Directors		Years of Service
President	Paul Sanborn	29
Vice-President	Josh Kelly	4
Treasurer	Vicki Bobbie	13
Secretary	Kristin Giannotti	6
Director	Maryanne Reavie	6
Director	Sabrina Dosanjh-Gantner	3
Director	Kyla Wilhelmsen	2

Staff

EXECUTIVE DIRECTOR TERRI MCCLYMONT

Terri is the Executive Director of the organization. She has been associated with REAPS for 28 years and is responsible for the day-to-day management of the organization. She has designed and implemented the majority of REAPS' programs. In her role as Executive Director, Terri has been nominated for and received many awards, such as the *Northern BC Today's Woman Forging Our Future with Education Award*. She was also nominated for the *Today's Women In Leadership Award* and the *Community Enrichment Award*.

SEASONAL AND OCCASIONAL HELP

As far as possible, the society makes use of youth employment programs to further its objectives and to provide educational opportunities for the youth. Each year, REAPS employs summer help with the assistance of the Canada Summer Jobs. These workers are on career placements and REAPS accepts university interns for periods of two to twelve months. They provided support in maintaining the garden and composters, in educating visitors, in carrying out community outreach programs and in assisting visitors.

VOLUNTEERS

REAPS has a stable core group of volunteers who have displayed a long-term commitment to waste reduction initiatives and REAPS' other programs. Last year, volunteer time accounted for 347 hours of REAPS' work.

OTHER PARTNERS

REAPS continues to form partnerships with local organizations to assist in the delivery of waste reduction educational programs and promotion. Such as:

- Regional District of Fraser-Fort George
- City of Prince George
- Boy Scouts and Girl Guides
- Prince George Public Interest Research Group
- Exploration Place
- Immigration and Multicultural Services
- Handicapped youth groups
- Service clubs
- Prince George Regional Correctional Centre
- UNBC
- Ministry of Environment and Climate Change Strategy
- CNC
- Northern Interior Health Unit Vocational Rehabilitation
- AimHi
- Everyone at the Table (EAT)
- Department of Fisheries & Oceans
- Railway and Forestry Museum
- Regional Correction Centre
- The Exploration Place
- Public and private schools
- School District 57
- Local businesses and industry
- Non-profit groups
- Prince George Public Library
- RDFFG Recreation Committees
- Ministry of Forests
- Group homes
- Everyone at the Table
- Court directed Community Work Service
- David Douglas Botanical Garden Society

Impacts of COVID-19

During the period of the Global Pandemic March 2020 to fall 2022 REAPS was forced to change and adapt many of its programs. REAPS adjusted the delivery of presentations from in person to online (for school presentations and community presentations). REAPS staff had to adjust to working in isolation and to the reduced volunteer effort that was available to assist with programming.

REAPS was also challenged by not being able to host or participate in community events in which it has historically had a presence. Fundraising was also a significant challenge with a reduction in opportunities to generate fundraising revenue. We also experienced difficulty recruiting qualified summer students.

REAPS has shifted staff work, program delivery, engagement opportunities, and meaningful donor interactions online in an effort to weather changes brought on by COVID-19. It has been difficult but REAPS was able to find innovative ways to survive through the pandemic, to deal with the waves of change and uncertainty, and to continue to meet its RDEFG commitments and obligations.

Alignment with City of Prince George Pillars

REAPS understands that the City of Prince George has advanced several priorities for the coming years including reconciliation, environmental protection, and climate action. REAPS is aligned with the City in these areas and the following sections outline specific work REAPS undertakes to support and advance these priorities.

RDEFG Regional Solid Waste Management Plan

REAPS' programs are directly integrated and complement the Regional District's Solid Waste Management Plan. REAPS was consulted as a stakeholder in the current and past plans. REAPS' programs act as a local clearinghouse for waste reduction and recycling information through our website, Facebook, workshops and classroom activities; as well as REAPS backyard composting education through workshops, website, compost demonstration garden and hotline. The latter function was seen as integral to the promotion by the Regional District of a means to reduce the amount of waste in the City of Prince George – the largest municipality within the RDEFG. REAPS' link with formal education was also documented. REAPS also undertakes curriculum-linked classroom activities in addition to setting up schools with composting programs and used beverage containers recycling programs.

It is clear from the Regional Solid Waste Management Plan that REAPS, while an independent entity, is integrated into the region's waste management services.

Reconciliation with Indigenous People

REAPS adopts the definition of truth and reconciliation from the Truth and Reconciliation Commission. REAPS recognizes that truth and reconciliation is an ongoing and evolving process and that every interaction with Indigenous Peoples and non-Indigenous people is an opportunity to advance truth and reconciliation. REAPS further recognizes that truth and reconciliation will be distinct to the First Nations, Inuit, and Métis peoples. When presenting to the community REAPS delivers a land acknowledgement and provides the opportunity for a cultural leader to open workshops and presentations.

REAPS uses salmon as an indicator species as a way to measure the health of the local environment; many of the areas REAPS targets can be brought back to salmon – recycling, water conservation, climate change, and consumption. To support its reconciliation journey REAPS is engaged with two First Nation schools, Regional

Correction Centre and with aboriginal educators in the school district 57 to use salmon as a bridge between cultures, stewardship of the environment, and empowering youth to become advocates of our environment.

REAPS engaged with a First Nation Artist (Clayton Gautier) to provide meaningful representation of First People's connection to salmon and create a meaningful poster illustration and descriptive details. With permission this poster is now used across Canada in the program and is provided for reference in Appendix A.

REAPS has partnered with Everyone at the Table (EAT) to create and maintain the Canning Circle Outreach Program. The Canning Circle increases the accessibility of nutrient rich healthy food for low-income individuals and families. This is of vital importance, as low socioeconomic status households have greater access to unhealthy foods and reduced access to healthy foods, which has resulted in higher rates of obesity in these households. Many groups have been involved with the program including Lheidli T'enneh Health, the Native Friendship Centre, Farm to School BC, the Everyone At the Table collective, the Good Food Box, The Salvation Army Food Bank, the South Fort George Family Resource Centre, PG Preserving Club volunteers and other community members passionate about local food security. Many learners chose to return weekly or monthly because they value the objectives of the project. Participants become knowledge teachers and inspiration, passing on what they learned through mentorships.

The Canning Circle is contributing to reconciliation as Indigenous and non-Indigenous members of the community work side by side connected by a shared goal of food security for all. The Circle is meant for everyone and it works to support equity and inclusion and reduce the stigma and discrimination associated with poverty.

The food created is delivered and donated to recipients and The Canning Circle has allowed local food security project partnerships to grow and develop such as with the Salvation Army Food Rescue Program, the Good Food Box, Baby's New Beginnings, Knights Inn, Positive Living North, the Firepit, Uniting Northern Drug Users, Harmony House, and local Warming Centres. Through the Canning Circle REAPS, and its partners, celebrate diverse cultures and traditions through food and ensure equity and inclusion guided by a cultural consultant and elders. To-date, the program has diverted over 1200 kg of food waste from the landfill.

This program aligns with RDEFG values but is not part of the REAPS contractual obligations; the Canning Circle is funded by MyPG grants, the BC United Way, and the Public Health Association of BC.

Enhancing Local Agriculture

Food security and local agriculture are becoming increasingly prominent and important in Northern BC and for REAPS. As described REAPS is actively involved with local food security through the Canning Circle program which reduces food waste, improves access to nutritious food, and encourages community collaboration. REAPS also supports the Good Food Box Program which provides regionally grown, fresh, nutritious, and affordable fruits and vegetables to hundreds of individuals and families each year. Providing produce grown regionally increases freshness and nutrition while supporting our local economy and our local growers, contributes to the health of our planet by greatly reducing the carbon footprint of food transport, and strengthens the local food sustainability, security, and sovereignty. Many of the educational programs and resources REAPS offers are aligned with enabling gardening, composting, and food production at home.

Protecting the Environment

Protecting the environment and environmental action are foundational to REAPS. All REAPS programs discussed throughout this proposal support environmental action in one way or another and this will be a continued focus for REAPS in the years to come. A selection of REAPS programs which help to protect the environment include:

the Canning Circle, school programs like 7Rs, business organic waste collection, backyard composting workshops, repair-it and waste reduction guides, Junk in the Trunk, and ideas to 'green' activities and holidays.

Taking Action on Climate Change

When REAPS was founded climate action was not a core reason for delivering its services but recycling and waste reduction are fundamental activities in addressing climate change. These activities have always been the foundational topics and programs of REAPS and will continue to play a major role in its services. As discussions and actions related to climate change have evolved, REAPS has developed new programs and engagement opportunities to provide education to those with whom it engages. REAPS now offers a number of school presentations that encourage students to engage, discuss, learn, and change behaviours to support climate change mitigation. Other REAPS programs like supporting local agriculture, encouraging home composting and gardening, providing repair and resale options, and providing business waste audits all provide meaningful avenues to support climate change mitigation and adaptation actions.

Community Outreach and Engagement

REAPS carries out a varied and considerable outreach and engagement program. The society works with both adults and children in the City of Prince George.

REAPS reaches and engages with the community in a variety of ways including:

- participating in annual events like Earth Day, Seedy Saturday, and Compost Week;
- engaging with and invite First Nations in the region to participate its programs;
- answering community questions via phone call, email, and in person visits;
- delivering community workshops like the 'It's Easy Being Green' series at the PG Public Library;
- delivering school presentations and programs like the 'Adopt-a-Worm' program;
- providing local business organic waste collection and waste audits;
- releasing regular publications and newsletters to its membership;
- promoting water conservation, air quality, stormwater management
- maintaining a presence on a variety of social media platforms; and
- growing existing and fostering new partnerships throughout the City of Prince George.

A complete list with additional detail is included in Appendix B.

REAPS completed a major redesign and update to its brand standard and website. This project was supported financially by the Northern Development Initiative Trust (NDIT) and REAPS worked closely with Splash Media to complete the work. REAPS now has a new logo and brand standard which is being rolled out to all of its digital and print media. The new logo reflects the future of REAPS while paying homage to its roots. The REAPS website has also received a major update to stay current with web based technological changes and improve accessibility and ease of navigation on the site. This project has gone a long way to future-proof REAPS media and brand and provides a strong platform on which to build out its educational resources.

The ongoing community outreach and engagement carried out by REAPS continues to garner support from various community members and organizations, some of which have provided letters of support which are available in Appendix C.

Compost Demonstration Garden

Purpose

The compost demonstration site was conceived in 1993 to show how recycling yard and kitchen wastes could reduce pressure on the landfill. The idea was to provide the community with a resource to introduce composting techniques as solutions to organic waste management and to increase understanding of landfill pressures.

Product

In 1994, the REAPS' Compost Demonstration Garden was completed on a Prince George City site with funding from the federal Environmental Partners Fund, local businesses and various government agencies. The site, which is adjacent to Lheidli T'enneh Memorial Park (LTMP), includes indigenous and non-indigenous perennial, vegetable, fruit and bog gardens and 14 different composting units within its 500 square metre area. A fully serviced office, garden shed, greenhouse and pergola have been built to meet the operational requirements of the site.

Although records are incomplete, the cumulative investment of volunteer time and donated goods and services in the establishment of the garden, and in improvements to the adjacent leased City building at 1950 Gorse St. is substantial. The available information is tabulated in Appendix E.

Moving Forward

After 27 years of operation and over 30,000 visitors on this site the land was given back to Lheidli T'enneh by the City of Prince George. REAPS took this opportunity to plan for the future and partner with the David Douglas Botanical Garden Society in their expansion project at UNBC. Through this partnership REAPS has subleased 1/3 acre to rebuild an enhanced **Growing Knowledge Community Compost Garden**. REAPS is excited about the creation of a bigger education space for schools, the public, community groups, and businesses to visit. This will provide additional opportunities for learning through REAPS' many workshops and for capturing opportunities for supporting food security in the area.



Figure 1. Design concept for expanded botanical garden at UNBC, developed by David Douglas Botanical Garden Society (DDBGS)

Timeline

REAPS has been actively fundraising for the construction of the Growing Knowledge Community Compost Garden and has secured an architectural design concept. The initial plan for civil works at the site includes ground clearing, leveling, and top-dressing in spring 2023. Additional work to install fencing, composters, and

garden beds is planned for early summer 2023. Planting for the community garden will commence thereafter. Continuation of the garden design and development will be addressed as funds are raised. It is our hope that completion of the site will be in the fall of 2024.

Operational Program

Through community partnerships REAPS will continue to provide environmental education in the community of Prince George.

Exploration Place has provided (2022) and agreed to provide the ExPlace Gardens for REAPS to demonstrate composting, vermicomposting, water saving, organic gardening, education learning area for school groups, residents and general public during the spring / summer 2023. The Garden is open five days a week during business hours and, from May to the end of September. Produce grown continues to go to local food banks for distribution or into food production for their clientele.

REAPS will be partnering with the YMCA CCRR Active Play again in 2023 engaging youth at various parks throughout the City of Prince George and RDFFG during the summer.

REAPS is currently hosting monthly environmental workshops at the downtown branch of the Public Library.

REAPS will be hosting monthly zoom and in person workshops at their office space. This office space was generously provided by Industrial Forestry Services Ltd. (IFS) in March 2022 when IFS heard that REAPS had to evacuate its long-time Gorse St. location on short notice. IFS has agreed to continue to provide this space for REAPS in 2023 to have a stable location from which to work, while continuing our community engagement, school programming and environmental education outreach.

Composters

A variety of units, including the Green Genie, Soil Saver, Earth Machine, chicken wire, wood and pallet composters will be relocated to the Growing Knowledge Community Compost Garden. Through our Organics Waste Diversion Collection Program six (6) to nine (9) businesses participate in diverting their kitchen wastes which are collected twice weekly to feed our worms (vermicomposting) and our composters. An agreement with the Farm owned by Lynn and Ed Gilliard near the Hudson Bay Wetlands will see more organics collected from local businesses to help reduce the impact of landfilling at the Regional Landfill.

Project Budget

As part of REAPS' partnership with the David Douglas Botanical Garden Society, a landscape architect, Mr. Jay Lazzarin, has prepared a construction cost estimate for the Growing Knowledge Community Compost Garden.

The cost estimate for the full project, including site preparation, supply of growing medium, fencing, raised beds, buildings (office, gazebo, greenhouse), irrigation system, utility connections, and access road and parking lot, comes to **\$463,330.87**, as of April 5, 2023. Full details are provided in Appendix D.1 of this Proposal.

Quotations and detailed plans for selected services and materials required for the initial stages of the project are currently being sought from local suppliers. The electrical site plan, prepared by McElhanney, is attached (Appendix D.2).

Contribution Sought from City of Prince George

REAPS is requesting that the City provide **\$100,000** as a contribution in-kind and/or as a cash donation toward the project cost. This would enable the critical initial project components to proceed in a timely manner in the spring of 2023: final grading and top dressing of the garden site, installation of water and power connections for the office building that will be moved to the site, and installation of 4 water standpipes within the garden.

Conclusion

REAPS brings a variety of direct and indirect services as well as promotional and education services to its partnership with the City of Prince George. In doing so, it has assisted the City of Prince George to reduce its solid waste disposal costs and has supported the City of Prince George's effort to strengthen its environmental profile.

With the financial contribution the partnership between the City of Prince George and REAPS will continue to be aligned around community priorities such as reconciliation, local agriculture, environmental protection, and climate action. REAPS will continue to prioritize program delivery opportunities and engagement and outreach in Prince George.

With the assistance of financial donations, volunteers, donations-in-kind, fundraising, internships, and grants from BC Gaming, the Ministry of Environment and the Department of Human Resources and Skills Development Canada, REAPS has been able to provide services year-round.

To facilitate the initial construction stages of the Growing Knowledge Community Compost Garden, REAPS is requesting that the City of Prince George contribute monetary and/or in-kind assistance in the amount of \$100,000.

Over its 30+ year history, REAPS has proven to be adaptable and responsive as new environmental challenges emerge in our City, Region, and beyond. Over the next 1-2 years, as we deal with continued COVID-related uncertainties, inflationary pressures, and the rebuilding of our educational facility, we will respond as we always have, relying on our community supporters, partners, and volunteers. But we are confident that we'll overcome these obstacles and will continue to play a significant role in promoting environmental stewardship in our community.

Appendix A - The Sacred Salmon Journey



THE SACRED SALMON JOURNEY

This mural is an Indigenous representation of the salmon lifecycle and the connections of salmon to land, water, sky and people. The artist Clayton Gauthier is a Cree/Dakelh Artist who resides in Prince George, BC. Clayton works with youth in the school district and in his home community to share art and storytelling. In this piece, Clayton honours the salmon's journey and all they gift us. We share gratitude for all the gifts that salmon provide.



Middle

SALMON feed all in their path - from the mountains to the sea. The circle depicts salmon's lifecycle; salmon travel from rivers to the ocean (feeding the orcas) and return to the rivers (feeding our forests, insects and animals).



Right of Centre

SEA LION symbol of strength & travel.



Left of Centre

BEAVER protector of the animal kingdom; feeds the forest and themselves with the salmon.



Bottom Right

BEAVER teaches productivity and teamwork; creates a greater variety of habitats for plants and animals.



Top Middle

EAGLE sits in the spiritual and physical world at the same time as shown by the moon, sun and stars. Inside the eagle's wings are feathers which represents friendship, honour and the path of life. Feathers are used in many ceremonies. The eagle sits in the spirit world and the physical world at the same time, the feathers bless us with their gifts of love, loving all that the salmon provides for.

All of these animals have gifts and responsibilities to mother earth. They have been here since the beginning and honour their responsibilities every day. We also have responsibilities to the land, water and sky. We need to do our best to stay in balance and the salmon provides a lot of that for us, giving us health, wealth and prosperity.



Bottom Left

CEREMONY celebrate through drum and song, giving thanks to the salmon.



Bottom Right

PLANTS used for medicine; fertilized by salmon's bodies.



Middle + Bottom Right

HARVESTING THE SALMON is part of cultural identity, spirituality and way of life. Men and women work together to feed their children and teach the next generation through their thoughts and actions. The men are harvesting and the women are preparing the salmon.



Middle + Bottom Right

MOON AND SUN symbols of rebirth, strength and power like the salmon. We all flow with grandfather sun and grandmother moon. They are in balance like the salmon that honour us by returning each year.

Salmon's Prayer

"Creator, we thank you for all that we have been gifted with... water, land and sky. We thank you for all that the salmon provide for us... we thank you for the food, nourishment, health and prosperity that you gift us each day. You provide for the orcas, the swimmers, the four legged, the two legged, the flyers and the medicine. Keep doing your powerful work and we will do ours... We love you for all that you do. - Mus siw baalga (Thank you, you honour us)"

Clayton would like to humbly thank Elders Tom Keeca from Y'mishian territory and Violet Bozoki from Dakelh territory for their support on this piece.

Printed on 100% recycled paper

Stream to Sea
Helping students become aquatic stewards

Find more salmon and stewardship education online
www.StreamtoSea.ca



Fisheries and Oceans
Canada



Fisheries and Oceans
Canada



Appendix B - REAPS Outreach

As well as its activities in the Compost Demonstration Garden, REAPS also carries on a varied and considerable outreach program. The society works with both adults and children in the communities of the Regional District. Community outreach continues to be offered in McBride, Dunster, Bear Lake, Valemount and Mackenzie. REAPS attends Farmers Markets each year in these rural communities sharing, answering and promoting recycling, composting and waste free lifestyles. RDEFG Recreation Groups have also participated in REAPS' programs. Each year, REAPS sends a letter to each Recreation Group outlining the programs and offering workshops to that community. The programs focus on backyard composting (choosing a composter, building compost, and caring for, maintaining and harvesting compost), vermicomposting, recycling, and reducing waste in the RDEFG.



REAPS is always willing to receive an invitation from communities to present, share or participate. In 2022 REAPS was able to provide the following outreach to regional communities:

- visited Farmers Markets in Dunster, McBride, Valemount, and Mackenzie;
- held a composting workshop with the Community Gardens in Mackenzie;
- provided school presentations in McBride Elementary and Valemount Elementary;
- participated with the YMCA Held environmental activities in Regional Parks (Hixon, McLeod Lake, Mackenzie, West Lake, Buckhorn, and parks in Prince George); and,
- provided recycling, vermicomposting, and water collection information to residents in Mackenzie, Valemount, and McBride via the hotline and email.

Staffing

The Executive Director position, funded in part by the Regional District partnership, occupies the lead role for operational, outreach and educational programs. A part-time Environmental Educator continues to assist throughout the fall and winter months. Summer Students are hired each year to provide environmental education during the spring and summer. Many volunteers assist with various outreach initiatives.

Yearly Events

Earth Day - poster competition at Public Library, media releases & Garden activities

Waste Reduction Week Challenge - all schools in the RDEFG

Seedy Saturday - food security

Recycle Crafts (Christmas, Valentine's Day, Easter) for school aged children

Kidz Art Day - Art Gallery

Green Day, Buy Nothing Day, Environment Week - media releases on how to make a Difference

Junk in the Trunk – largest community garage sale held at the CN Centre

Recycle Toy Drive - collected quality used toys for distributed to local child advocacy groups

Go For Green Week – recycled crafts for kids and information for parents

Compost Week- media releases on how to make a difference



First Nations

REAPS continues to engage with and invite First Nations in the regions to participate in our many programs. REAPS has a strong connection in the School District with the Aboriginal Education Workers.

Community Engagement

REAPS provides additional community engagement and support for a variety of questions related to its programs. An overview of the engagement totals for 2022 is provided below:

Table 3. Summary of 2022 Program Stats (Displaced from LTMP)

	JAN	FEB	MAR	APR	MAY	JUNE	JULY	AUG	SEPT	OCT	NOV	DEC	TOTALS
HOTLINE CALLS													
calls	12	14	34	42	31	37	18	33	28	17	13	5	284
emails	10	17	13	22	12	27	19	17	25	16	11	15	204
visitors	9	12	5	21	18	87	174	201	18	6	6	7	564
SCHOOL PROGRAMS													
presentat	1	2	5	9	21	20	0	0	3	9	12	7	89
participar	16	16	107	179	447	410	0	0	64	191	433	126	1989
WORKSHOPS													
presentat	1	1	1	1	4	4	9	22	5	4	4	4	60
participar	6	15	17	2	24	170	732	370	36	32	33	32	1469
REAPS COMMUNITY EVENTS													
event	0	0	0	3	0	1	5	0	1	0	0	0	10
participar	0	0	0	~2725	0	~800	32	0	~2200	0	0	0	~5757

Summary of 2021 Program Stats (Covid-19)

	JAN	FEB	MAR	APR	MAY	JUNE	JULY	AUG	SEPT	OCT	NOV	DEC	TOTALS
HOTLINE CALLS													
calls	18	15	27	70	39	39	24	19	35	17	22	15	340
emails	13	14	20	22	14	15	19	13	22	12	18	7	189
visitors	7	8	17	173	173	251	330	544	175	79	37	12	1806
SCHOOL PROGRAMS													
Presentations	2	6	2	11	10	9	4	0	1	13	28	11	86
participants	23	129	45	18	196	189	60	0	15	302	613	282	1790
WORKSHOPS													
Presentations	4	6	3	7	6	5	7	5	1	2	2	1	48
participants	8	12	7	37	22	12	9	9	1	6	10	2	135
REAPS COMMUNITY EVENTS													
events	0	0	0	1	2	0	1	0	0	0	1	0	5
participants	0	0	0	3047	143	0	51	0	0	0	175	0	3416

Summary of 2020 Program Stats (start of Covid-19)

	JAN	FEB	MAR	APR	MAY	JUNE	JULY	AUG	SEPT	OCT	NOV	DEC	TOTALS
HOTLINE CALLS													
calls	30	41	57	75	69	66	33	34	44	41	19	7	516
emails	19	12	15	12	56	62	25	27	22	35	18	12	315
visitors	10	12	9	17	153	259	167	210	135	78	12	5	1067
SCHOOL PROGRAMS / WORKSHOPS													
zooms / in person Presentations	3	13	4	32	14	18	14	7	7	11	21	1	145
participants	57	294	84	13	6	42	12	27	45	164	38	21	803
REAPS COMMUNITY EVENTS													
events	1	1	2	0	0	0	0	0	0	0	0	0	4
participants	21	8	133	0	0	0	0	0	0	0	0	0	162

Summary of 2019 Program Stats

	JAN	FEB	MAR	APR	MAY	JUNE	JULY	AUG	SEPT	OCT	NOV	DEC	TOTALS
HOTLINE CALLS													
calls	29	27	65	127	90	56	66	55	61	49	25	38	688
visitors	19	21	39	165	757	652	69	404	132	27	73	23	3003
SCHOOL PROGRAMS / WORKSHOPS													
Presentations	2	13	9	17	41	35	14	8	15	23	7	8	192
participants	42	485	171	344	786	718	99	84	280	443	136	157	3745
REAPS COMMUNITY EVENTS													
events	0	2	2	2	8	15	11	1	1	2	1	1	46
participants	0	6	147	520	35	35	1043	482	17	~1700	73	3	2361

REAPS community engagement has rebounded after being significantly impacted by COVID-19. In-person events like workshops and school program delivery were impacted the most.

School Programs

REAPS delivers over 30 different school programs for free throughout the RDFFG. The *Adopt-a-Worm*, *Dumpy the Overfed Landfill*, and the *School Recycling Club* are perennial flagship programs delivered by both paid staff and volunteers. Examples of REAPS other programs are:



A school newsletter is sent out monthly to schools highlighting what students can do for the environment, cool facts about worms (support our Adopt A Worm Classrooms), recycling opportunities, and more.

Flagship School Programs

The above school programs have been introduced many times over the years. However, there are four well-established programs which have been offered consistently over a much longer period. These programs are adaptable to children from kindergarten to grade 7.

Adopt-a-Worm Program

As part of REAPS' outreach program, the Adopt-A-Worm Program was developed in 1996. The Executive Director and the Environmental Educators visit each classroom with a presentation about worms and vermicomposting. The program teaches children how to reduce their lunch wastes by composting with the worms. To encourage these new vermicomposters, REAPS developed a newsletter, *Castings*, to answer questions and facilitate communications between the various schools. The red wigglers are provided to the schools by REAPS and, in June, the worms are returned to The Garden where they continue their educational role for Garden visitors.

'Dumpy', the Overfed Landfill

Dumpy the Overfed Landfill program was developed in 1997. The program fulfills environmental aspects of the curriculum and is popular with teachers and students. Dumpy has performed on PGTV with the Pinewood Elementary Grade 5 class and appears at a variety of community events. He is an interactive mascot that teaches elementary school children about the importance of recycling and other forms of waste reduction. A skit starring *Dumpy* deals with the issues of the regional landfill garbage. The children all love to hear stories about Dumpy's weight problem and enjoy devising solutions. After the skit, the school children are asked to separate their garbage into recyclable and non-recyclable categories.

School Recycling Club

The School Recycling Club was developed for elementary and high school students in October 1998. Its objective was to foster environmental stewardship by focusing on waste management. REAPS delivers informational packages providing guidelines for setting up a recycling club to schools throughout the region. It proposes a group process in which important questions are

considered. Some schools that have requested information on this program or have received a presentation are:

- Mackenzie Secondary
- Dome Creek Elementary
- Dunster Fine Arts
- Buckhorn Elementary
- Highglen Montessori
- Bear Lake Elementary
- Nukko Lake Elementary
- College Hts. Elementary
- Sacred Heart
- Immaculate Conception
- McBride Secondary
- Valemount Elementary

School Engagement and Connections

For the past six years, REAPS has hosted and sponsored the *Earth Day* poster campaign and the School District 57 *Waste Reduction Week Challenge*. The program challenges participating classes to reduce their classroom waste during the week. The class with the least amount of waste per student wins two hundred dollars.

The Central Interior Science Exhibition (CISE) welcomes young scientists from Prince George, Quesnel, and Lakes School Districts. REAPS has been a sponsor for over fifteen years. The R.E.A.P.S Science Award is presented with the criteria: A student in grades 4-7 for an outstanding project that focuses on the 3 R's (reduce, reuse, and recycle). This award consists of a plaque and a \$50.00 cash prize.

Business Organic Waste Collection

REAPS collects organic waste from 6 to 9 Prince George businesses twice weekly from May to September and uses the material in its composters and vermicomposters. These composters annually reduce about 3,000 kilograms of organic business waste to our compost garden.

Publications

- *Castings* is the newsletter that compliments the school Adopt-a-Worm projects. REAPS produces it monthly from September to June.
- *REAPS Reader* is a newsletter of environmental information for schools. It is published on the reverse of the *Castings* newsletter. It is published monthly from September to June.
- *REAPS Report* is a bimonthly publication with both print & internet editions. Its regular features include: REAPS News, Tip of the Month, Local News, Recycle Craft, Around BC, Coming Events, Around the World, Web Pick of the Month, Book of the Month

Community Workshops

REAPS offers a variety of community workshops according to the needs expressed by the community. Some of those workshops take place at the garden, while others may be given anywhere that a group would like hosted.

Hotline

The REAPS hotline fields hundreds of inquiries from the general public about where to purchase composters and how to use them. The hotline also provides support for REAPS education programs. The society continues to respond to telephone requests for information. It receives questions on a plethora of subjects. Some examples include:

- composting technical information
- regional landfill's compost
- recycling
- where to purchase composters
- where to purchase hardy plants
- which composter works best for what needs
- where to purchase soil
- information about rain barrels
- homemade household cleaners
- natural pest control methods
- vermicomposting
- information on other recycling groups
- landfill and transfer station information

Public Service Announcements

REAPS uses community service announcements to notify the public of workshops, events and seasonal tips. Promotions and announcements have changed from newspapers, posters and radio announcements to Facebook advertisements or on our Facebook page and then sharing to a variety of community platforms, REAPS also has an Instagram page to promote the 7Rs. We are often invited to CKPG for interviews on our various initiatives. We will post our events on various community event boards hosted by TourismPG, local radio stations, and Citizen. The objectives are to offer tips on composting, gardening, recycling and other waste reduction alternatives and to give notice of REAPS workshops and events.

Business Outreach

REAPS provides the following services to business:

- REAPS continues to promote *Organic Business Waste Collection* for waste disposal and offer waste stream alternatives to local businesses.
- REAPS provides business waste audits & assessments throughout RDFFG.
- REAPS monitors where the IC&I sectors may divert their commercial waste and identifies opportunities for businesses based on recycling.
- REAPS provides *Green Office* presentations throughout the region.
- REAPS has a monthly *Green Office* newsletter available to all.

Workshops

REAPS provides the following activities in workshop format:

- REAPS hosts composter and vermicomposter construction workshops.
- REAPS presents public education workshops monthly.
- REAPS partners with the PG Public Library to provide monthly workshops for the community.
- REAPS hosts the Junk in the Trunk (largest garage sale in the RDFFG) in the spring and fall.

Partnerships

REAPS maintains and seeks out partnerships in the communities in which it operates including:

- REAPS encourages gardeners to participate in *Grow A Row* for the Food Bank campaign.
- REAPS partners through a gleaning program with the Salvation Army with the Canning Circle to reduce food waste.
- REAPS partners with many children advocacy groups through *the Recycled Toy Drive*.
- REAPS continues to promote and assist with the *Annual City-Wide Spring Clean Up Campaign*
- REAPS is willing to expand and extend REAPS' partnership with RDFFG.
- REAPS continues to provide practical work within REAPS for the education of youth, young adults, students and individuals that are court appointed to complete community hours.

Appendix C - Letters of Support



DAVID DOUGLAS BOTANICAL GARDEN SOCIETY

PO Box 1305 Prince George, BC V2L 4V3

www.ddbotgarden.bc.ca

May 14, 2023

The City of Prince George
1100 Patricia Blvd
Prince George, BC V2L 3V9

Dear Mayor and Council,

On behalf of the Society, I am writing to express our very strong support for the Recycling and Environmental Action Planning Society (REAPS) request for adequate funding to facilitate the move to their new location on the David Douglas Botanical Garden Expansion site.

REAPS has provided a valuable resource to the community for over 30 years and it is unfortunate that they have had to move from their established location. It has caused considerable work, adjustment, and expense to temporarily relocate, and even with this major disruption, they have continued to offer their usual programs and serve the community.

REAPS will incur considerable expense to relocate, not only in rebuilding, but in servicing the site with a final grading, installation of water and electrical services and fencing.

Th Society is incredibly pleased to be able to sub-lease a portion of our site to REAPS and are looking forward to working with them, as many of our goals are similar. Unfortunately, we do not have the resources to provide financial support to help them move and get established.

We believe that, as the City has instigated this move, they should treat REAPS respectfully and assist them financially and/or in kind in order that they are able to continue offering their fine services to the community.

Yours truly,

Linda Naess
President

City of Prince George
1100 Patricia Blvd
Prince George, BC V2L 3V9
Lheidli T'enneh Territory

Dear Mayor and Council:

For over 30 years, the Recycling and Environmental Action Planning Society (REAPS) has raised community awareness on the importance of the seven Rs – reduce, reuse, recycle, rethink, refuse, repair, regift – and the resources available locally to help guide Prince George residents adopt a more sustainable lifestyle.

REAPS carries out a varied and extensive outreach and engagement program in the communities of the Regional District. REAPS is an established community organization consistently providing valuable opportunities and connections within the community.

As a long-time resident in Lheidli T'enneh Territory / Prince George, I am asking you to support the organization's request of in-kind or monetary support to provide water and electrical connections for REAPS' Growing Knowledge Community Compost Garden this June.

Sincerely,

Dara Campbell
924 Inez Cres
Prince George, BC V2M 5A4
Lheidli T'enneh Territory



Fisheries
and Oceans
Canada

Pêches
et Océans
Canada

The City of Prince George
1100 Patricia Blvd.
Prince George, BC V2L 3V9

Dear Mayor and Council:

For over 30 years, REAPS have raised community awareness on the importance of the three Rs and the resources available locally to help guide residents in adopting a more sustainable lifestyle. REAPS carries out a varied and considerable outreach and engagement program in the communities of the Regional District, including a longstanding history of providing exceptional support to the Salmonids Classroom Program and other DFO initiatives.

REAPS is a stable community organization consistently providing valuable opportunities and connections within the community.

I would like you to support their request of in-kind or monetary support to provide water and electrical connections for their Growing Knowledge Community Compost Garden this June.

Kind regards,

Tyler Thibault
Community Advisor
Fisheries and Oceans Canada
236-330-8175

Canada 



University of Northern British Columbia
3333 University Way, Prince George, BC, Canada, V2N 4Z9

May 10, 2023

The City of Prince George
1100 Patricia Blvd.
Prince George, BC V2L 3V9

Dear Mayor and Council:

For over 30 years, certainly the length of time I have lived in Prince George, REAPS has been actively involved in raising community awareness on the importance of the three Rs and the resources available locally to help guide residents in adopting a more sustainable lifestyle. They have certainly been a critical educational resource for me as a UNBC professor, have happily contributed to my courses at UNBC, benefitting students and the community equitably and also offering important summer job experience for students seeking such important documented experience on their resume.

REAPS is well known for carrying out a varied and important outreach and engagement program in the communities of the Regional District of Fraser Fort George, and have little competition in doing so, as we have almost no other NGO offering such a broad variety of activities, from education on vermiculture to organizing Junk in the Trunk to reduce items landfilled.

REAPS is a stable community organization consistently providing valuable opportunities and connections within the community.

I ask that you fully support their request of in-kind and monetary support to provide water and electrical connections for their Growing Knowledge Community Compost Garden this June. They are a worthwhile investment in the long term future of this community.

With respect,

Annie L. Booth PhD, MES, BA, MCIP, RPP
Professor
Environmental and Sustainability Studies
University of Northern British Columbia
3333 University Way
Prince George, British Columbia
V2N 4Z9 Canada
250-960-6649
annie.booth@unbc.ca

The City of Prince George
1100 Patricia Blvd.
Prince George, BC V2L 3V9

May 9, 2023

Dear Mayor and Council:

REAPS has been an integral part of this community for over 30 years. Their impact is immeasurable for the many programs, workshops, and events they offer to our youth and general public. The uproot of the Community Garden has a vast impact on many of the programming that has been operating for many years. The success and timeliness of the Growing Knowledge Community Compost Garden should be considered an integral part of the community in times of climate change.

I would like you to support their request of in-kind or monetary support to provide water and electrical connections for their Growing Knowledge Community Compost Garden this June.

Sincerely,

Kyla Wilhelmsen
Homespun Refillery Inc.



Terri McClymont

From: Elizabeth Maclsaac [Redacted]
Sent: May 10, 2023 4:57 PM
To: REAPS (Terri)
Subject: Letter of Support

The City of Prince George
1100 Patricia Blvd.
Prince George, BC V2L 3V9

Dear Mayor and Council:

For over 30 years, REAPS have raised community awareness on the importance of the three Rs and the resources available locally to help guide residents in adopting a more sustainable lifestyle. REAPS carries out a varied and considerable outreach and engagement program in the communities of the Regional District.

REAPS is a stable community organization consistently providing valuable opportunities and connections within the community.

I would like you to support their request of in-kind or monetary support to provide water and electrical connections for their Growing Knowledge Community Compost Garden this June.

1

Sincerely,
Elizabeth Maclsaac
1765 5th Ave
Prince George, BC V2L 3M2

Sent from my iPhone

2

The City of Prince George
1100 Patricia Blvd.
Prince George, BC V2L 3V9

Dear Mayor and Council:

For over 30 years, REAPS have raised community awareness on the importance of the three Rs and the resources available locally to help guide residents in adopting a more sustainable lifestyle. REAPS carries out a varied and considerable outreach and engagement program in the communities of the Regional District.

REAPS is a stable community organization consistently providing valuable opportunities and connections within the community.

I would like you to support their request of in-kind or monetary support to provide water and electrical connections for their Growing Knowledge Community Compost Garden this June.

Sincerely,



Angelina Joiner, President

Prince George Naturalists Club



Prince George
Naturalists Club

The City of Prince George

1100 Patricia Blvd.
Prince George, BC V2L 3V9
May 14, 2023

Dear Mayor and Council:

For over 30 years, REAPS have raised community awareness on the importance of the three Rs and the resources available locally to help guide residents in adopting a more sustainable lifestyle. REAPS carries out a varied and considerable outreach and engagement program in the communities of the Regional District.

REAPS is a stable community organization consistently providing valuable opportunities and connections within the community.

I would like you to support their request of in-kind or monetary support to provide water and electrical connections for their Growing Knowledge Community Compost Garden this June.

Sincerely,

Redacted



Norm Easson

4420 Urquhart Crescent,

Prince George BC

V2M 5H1

The City of Prince George
1100 Patricia Blvd.
Prince George, BC V2L 3V9

To: Mayor and Council:

A big part of your role as our elected officials is to nourish the great work that is done in our community by groups like REAPS. REAPS has a long demonstrated history (over 30 years) of raising community awareness on the importance of Reduce, Reuse, and Recycle. It promotes the resources available locally to help guide residents in adopting lifestyles that are more respectful of all life forms on the planet. REAPS has been a constant, well known and reliable presence in our community consistently providing valuable opportunities and connections and it provides ongoing outreach and engagement programs in the communities of the Regional District.

Their forced move last year with basically no notice has been a real hardship that they have faced with courage and resilience. I request that you support their move with in-kind or monetary support to provide water and electrical connections for their Growing Knowledge Community Compost Garden this June.

In solidarity,

Alex Rowan

The City of Prince George
1100 Patricia Blvd.
Prince George, BC V2L 3V9

To: Mayor and Council:

It is always easy to write letters of support for REAPS. It is a powerful collaborator in innumerable right actions in our community. REAPS is a stable collaborative community organization with a long-demonstrated history (over 30 years) of raising community awareness on the importance of Reduce, Reuse, and Recycle. REAPS has been a consistent, well known, and reliable presence in our community, providing ongoing outreach and engagement programs in the communities of the Regional District of Fraser Fort George. I have spoken with many adults who still remember fondly that REAPS activities in school were their first awakenings to environmental concerns.

For the last two years, REAPS has enthusiastically endorsed and been the administrator for the Everyone At the Table projects in waste reduction and food security improvement: the Canning Circle and the Good Food Box. We have a lot of respect for their hard work and commitment to environmental issues.

Their forced move last year with basically no notice has been a real hardship that they have faced with courage and resilience. Part of your role as our elected officials is to nourish the great work that is done in our community by groups like REAPS. We request that you support their move with in-kind or monetary support to provide water and electrical connections for their Growing Knowledge Community Compost Garden this June.

In solidarity, Alex Rowan, Kym Gouchie and Roanne Whitticase

Everyone At the Table (EAT) <https://www.letseatlocalpg.com/>

The Good Food Box <https://www.thegoodfoodboxpg.ca/>

The Canning Circle <https://www.letseatlocalpg.com/canningcircle>

We wish to acknowledge the 9000+ years of the Lheidli T'enneh Nation's stewardship. The Lheidli T'enneh's ancestors have cared for this beautiful land that feeds us all and we will continue to welcome their teachings and ancestral knowledge as we work towards food security for all people.



PO Box 1779
Prince George, BC, V2L4V7
250.562.1612 | 1.866.562.1612

May 11, 2023

Dear Mayor and Council,

On behalf of The Exploration Place, I would like to voice our support for REAPS' request of in-kind or monetary support to provide water and electrical connections for their Growing Knowledge Community Compost Garden this June.

For over 30 years, REAPS has raised community awareness of the importance of the three Rs and the resources available locally to help guide residents in adopting a more sustainable lifestyle. REAPS is an important fixture in Prince George, carrying out a varied and considerable outreach and engagement program in the communities of the Regional District of Fraser-Fort George.

REAPS had been one of The Exploration Place's closest neighbours for three decades. We always look forward to bringing children from our summer camps to the REAPS garden to participate in their educational programming and we are happy to have recently partnered with them to enhance the climate change programming we provide. As a museum and science centre, The Exploration Place believes in the value of informal education and hands-on learning to plant a seed not only in young minds but in the minds of those of all ages that will help ensure an informed and healthy future. The programming that REAPS provides does just that. REAPS is a stable community organization that consistently provides valuable opportunities and connections within the community.

Thank you for the opportunity to provide our support for this request. Please do not hesitate to reach out if you have any questions or require any further information.

Sincerely,

Robyn Curtis
VP – Development & Partnerships
The Exploration Place
robyn.curtis@theexplorationplace.com | 250.562.1612

The City of Prince George
1100 Patricia Blvd.
Prince George, BC V2L 3V9

Dear Mayor and Council:

For over 30 years, REAPS have raised community awareness on the importance of the three Rs and the resources available locally to help guide residents in adopting a more sustainable lifestyle. REAPS carries out a varied and considerable outreach and engagement program in the communities of the Regional District.

REAPS is a stable community organization consistently providing valuable opportunities and connections within the community.

I would like you to support their request of in-kind or monetary support to provide water and electrical connections for their Growing Knowledge Community Compost Garden this June.

Sincerely,

Bronwen Coverdale



Bronwen Coverdale
Branch Manager

3596 Massey Drive
Prince George, BC
V2N 2M4

250-563-1292 x 45853 Tel
250-565-7727 Cell
250-563-8279 Fax
1-800-665-1292 Toll Free

bronwen.coverdale@nedco.ca
www.nedco.ca



SACRED HEART SCHOOL
785 Patricia Boulevard
Prince George, BC
V2L 3V5

PHONE: 250-563-5201
FAX: 250-563-5201
sacredheart@cispg.ca

May 11, 2023

To whom it may concern,

Greetings from Sacred Heart School! We have been involved with the REAPS Composting Garden for many years. Terri McClymont who runs the garden, visits our school regularly. She provides workshops for individual classes based on environmental issues including identifying wants and needs; plant lifecycles; recycling, reducing, reusing and excessive packaging.

The REAPS organization supplies us with worm-bins in which we deposit organic materials. The worm castings are applied to the soil in our school garden which reduces waste going to landfills. In October, we participate in the annual Waste Reduction Challenge which is sponsored by REAPS. During this week we try to significantly reduce the waste we create in the classroom. We divert unwanted materials to the compost bin and recycling bins for paper, cardboard, markers/pens and beverage containers.

In June, we visit the REAPS Composting Garden for workshops on environmental themes and we tour the garden. We also participate in a Pond Study which is provided by REAPS and based at Shane Lake which forms part of Forests for the World.

This is vital educational work which teaches our youngest children the importance of sustainable practices designed to leave a minimal footprint on the earth. The students in turn educate their parents and families at home about the environmental responsibilities they are learning at school. With climate change and the increased environmental impacts caused by human activities, this work was never more essential for the upcoming generation.

We at Sacred Heart School are most grateful to the REAPS Composting Garden for all the educational work which the organization supports at our school. The programs are provided free of charge to our students which is an added benefit. We support REAPS application and urge you to provide funding so that REAPS can continue the very important educational work they do at our school and at many other local schools in Prince George.

Yours sincerely,

N. Power,

Kindergarten Teacher

70 Years Treasuring Our Past, Mapping Our Future

The City of Prince George
1100 Patricia Blvd.
Prince George, BC V2L 3V9

Dear Mayor and Council:

For over 30 years, REAPS have raised community awareness on the importance of the three Rs and the resources available locally to help guide residents in adopting a more sustainable lifestyle. REAPS carries out a varied and considerable outreach and engagement program in the communities of the Regional District.

REAPS is a stable community organization consistently providing valuable opportunities and connections within the community. As an educator I appreciate how REAPS has provided invaluable education to the children of Prince George with the many school programs they offer.

I would like you to support their request of in-kind or monetary support to provide water and electrical connections for their Growing Knowledge Community Compost Garden this June.

Sincerely,

Marianne Brown
Grades 3 & 4 teacher
Nusdeh Yoh

The City of Prince George
1100 Patricia Blvd.
Prince George, BC V2L 3V9

Dear Mayor and Council:

I respectfully urge you to support REAPS' request for in-kind or monetary support to provide water and electrical connections for the Growing Knowledge Community Compost Garden currently being developed to replace the garden formerly located at 732 Gorse Street.

For three decades, REAPS has played a special role in Prince George and its surrounding region, serving as both an educational organization and a public service, using both roles to foster waste reduction and encourage sustainable practices in our community.

As a public service, REAPS works in partnership with local and regional governments to act as a clearinghouse of information on practical waste reduction and provide residents with information and/or options for recycling or reusing. REAPS assists residents to manage their resources better at the household level, and acts as a distributor of home composting units on behalf of the RDFFG and rain barrels on behalf of the City of Prince George, provided at cost. REAPS reports province-wide on stewardship programs for various recyclable items.

As an educational organization, REAPS involves a diverse range of community members, ranging from daycares to elementary and high school students to local businesses and residents. Whether it's showing children how to use earthworms in composting or visiting businesses to audit their waste streams, REAPS aims to meet people where they live, work, and study to improve awareness of waste reduction and demonstrate practical solutions. REAPS has been a placement for a student teacher in the NITEP – Indigenous Teacher Education Program who provided extension outreach on First Nation connections for our school programs.

REAPS also supports two First Nation schools and 20 other school partners with their aboriginal leaders through the '*Salmonids in the Classroom*' program from Fisheries & Oceans Canada. This teaches students history and songs about salmon and the important cultural connection of the First Nations' relationship with salmon. REAPS has collaborated with local artist Clayton Gauthier to recreate the *Salmon Vital Link Poster* which reflects a First Nation story of salmon and their spirit guides. The poster is now used nationally in the '*Salmonids in the Classroom*' program.

As a community member, REAPS continues to support many local initiatives around poverty alleviation, food security, waste avoidance, offender and inmate rehabilitation, community enhancement, and First Nation agriculture initiatives. REAPS supports and facilitates the Canning Circle, which gleans unwanted food that would otherwise go to the landfill and processes it into wholesome jams, soups, and other items that are then donated to organizations to distribute to those in need. The produce that REAPS grows goes into the community through the Food Bank and other service organizations. REAPS works with local advocacy agencies (Headstart, Fire Pit, Active Support Against Poverty, Hadih House, and others) for the Christmas distribution of quality used toys collected at our Recycle Toy Drives. REAPS organizes the biannual *Junk-in-the-Trunk* and facilitates the annual City-Wide Spring Cleanup.

REAPS has worked consistently to become a trusted source of practical advice for community members. A big part of that effort had centered on the Compost Demonstration Garden at Lheidli T'enneh Memorial Park. Despite its small size, every year several thousand community members visited the Garden to learn about composting and gardening techniques, through class tours, workshops, or individual visits and discussions with our staff and volunteers.

As a member of the Board of Directors, I was pleased to volunteer in and around the garden on some of the activities hosted there and to bring my grandsons to the summer activities hosted by REAPS' summer students. I am very excited to have an opportunity to participate in planning and developing a larger garden where more emphasis can be placed on growing food sustainably in an urban landscape. The Growing Knowledge Community Compost Garden will provide many additional opportunities for people to learn about and become environmental stewards.

I wholeheartedly support the garden expansion and urge the City of Prince George to do so as well, through in-kind or monetary support for this very worthwhile project.

Sincerely,

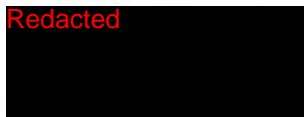
Redacted

Maryanne Reavie

Appendix D – Budget estimates and detailed plans:

D.1 - Budget for Growing Knowledge Community Compost Garden

R.E.A.P.S Garden

Construction Cost Estimate

April 5, 2023

Prices are for a Contractor to undertake all said work as illustrated on our 'Phase 2A Expansion' Concept Plan dated February 28, 2023. Unit prices include all disbursements, overhead, PST and profit.

1. Conceptual Design provided by D.D.B.G.S.	-
2. Final Grading	
- rough grading undertaken by DDBGS (Nahanni Construction)	\$ 625.00
- excavation of planting beds to 6" depth (35 cu.yd.)	
- backhoe / excavator (5 hr. @ \$125)	
3. Growing Medium	3,200.00
- delivery of growing medium (16 loads @ \$ 200 / load)	6,500.00
- growing medium for planting beds (100 cu.yd. installed @ \$65 /cu. yd.)	6,800.00
- growing medium for planter boxes (80 cu.yd @ \$85.00 / cu.yd.)	1,582.50
- edging for shrub plant beds 211 l.m. (heavy duty plastic) @ \$7.50/l.m	
4. Fence	1,500.00
- survey and layout	20,150.00
- 8'-0" ht. chain link fence @ 155 m. @ \$130 / l.m.	3,000.00
- two gates (12' opening plus 6' opening)	

5. Raised Planting Beds	
- 4x6 pressure treated timbers c/w 2x4 inserts	35,200.00
(12' l x 4' w x 2' ht.) @22 @ \$ 1,600.00 ea	4,400.00
(8' l x 4' w x 2' ht.) @4 @ \$ 1,100.00 ea	
6. Office / Maintenance Bldg. (future)	120,000.00
- single storey - 600 sq. ft. @ \$150 - \$250 / sq. ft.)	79,500.00
- water, power & sewage utilities from Visitors Centre (75 m length) installed @ 8'-0" to 10'-0" depth at \$ 1,060.00 / l.m.	
7. Compost Bins & vermicompost bins	
-twelve 3' x 3' x 3' -6" ht. wooden compost bins @ \$ 400.00 ea	4,800.00
- three 3' x 6' x 3' ht. plastic bins @ \$750 ea	2,250.00
	5,000.00
8. Entry Trellis / Arbour & signage (lump sum)	
9. Work Area & Entry Patio	
- 35 sq. m. interlocking concrete paver patio @ \$ 215.00 / sq. m	7,525.00
- 12 sq. m. interlocking concrete paver patio @ \$ 235.00 / sq. m	2,820.00
10. Greenhouse (10' x 16')	
- aluminum frame c/w glass siding @ \$100.00 sq. ft.	16,000.00
11. Gazebo c/w sitting area	
- 5.5 dia. wood frame c/w metal roof (custom built or stock item) L.S.	25,000.00
- five benches @ \$ 1,200 ea	6,000.00
12. Plant Material	
- supply & install 165 shrubs @ \$36.00 ea.	5,940.00
- supply & install 125 perennials @ \$14.00 ea.	1,625.00

-supply & install five (5) small trees @ \$350.00 ea	1,750.00
- 12 cu. yd. depth mulch spread @ 2" depth @ \$ 100/ cu. yd.	1,200.00
13. Gravel Surfacing (phase 1 only)	
- delivery of gravel	300.00
- ≈ 450 sq., m @ 2" (5 cm depth = 24 cu. m. @ \$ 75/m installed)	1,800.00
- filter fabric liner - 480 sq. m. installed	2,000.00
14. Irrigation system	
- mainline up to fence / perimeter of the site (DDBGS to provide)	-
- automatic irrigation system throughout shrub beds	25,000.00
-water faucets / quick couplers for raised planters	
- controller c/w wiring & PVC piping (lump sum)	
15. Access Road & Parking Lot (150 mm depth gravel surfacing - 115 cu. m. gravel)	
- share cost with Community Garden	7,500.00
16. Contingencies (10%)	
	39,920.00
	Sub-Total \$441,267.50
	GST 22,063.37
	TOTAL <u>\$ 463,330.87</u>

Prepared by,

Jay Lazzarin
Landscape Architect
Life member, British Columbia Society of Landscape Architects

D.2 – Electrical site plan

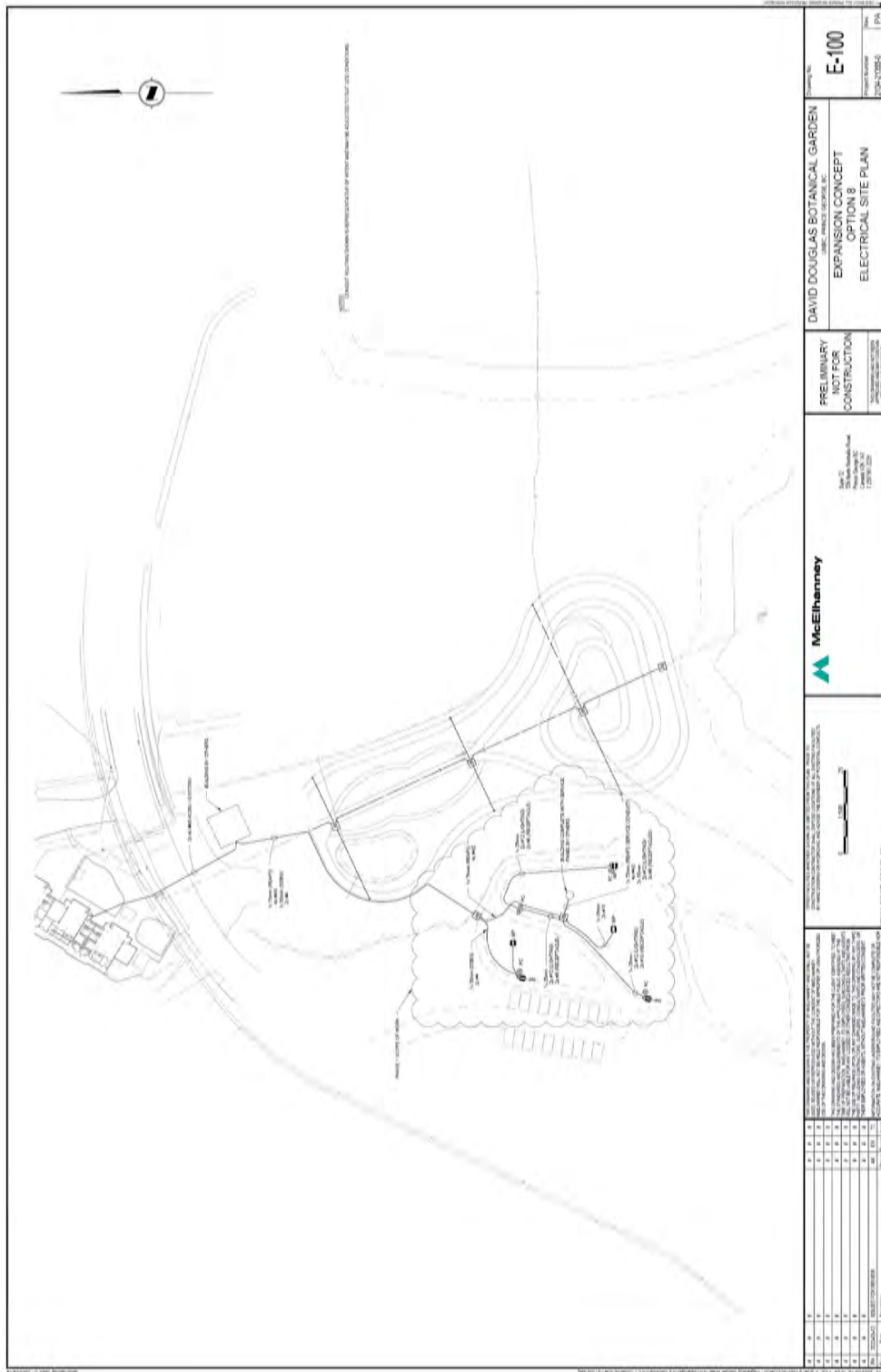

LIGHTING SYMBOL SCHEDULE	
SYMBOL	DESCRIPTION
1	100 WATT METAL HALIDE LIGHT
2	150 WATT METAL HALIDE LIGHT
3	200 WATT METAL HALIDE LIGHT
4	250 WATT METAL HALIDE LIGHT
5	300 WATT METAL HALIDE LIGHT
6	350 WATT METAL HALIDE LIGHT
7	400 WATT METAL HALIDE LIGHT
8	450 WATT METAL HALIDE LIGHT
9	500 WATT METAL HALIDE LIGHT
10	550 WATT METAL HALIDE LIGHT
11	600 WATT METAL HALIDE LIGHT
12	650 WATT METAL HALIDE LIGHT
13	700 WATT METAL HALIDE LIGHT
14	750 WATT METAL HALIDE LIGHT
15	800 WATT METAL HALIDE LIGHT
16	850 WATT METAL HALIDE LIGHT
17	900 WATT METAL HALIDE LIGHT
18	950 WATT METAL HALIDE LIGHT
19	1000 WATT METAL HALIDE LIGHT

LUMINAIRE SCHEDULE		
TYPE	DESCRIPTION	REMARKS
1	100 WATT METAL HALIDE LIGHT	
2	150 WATT METAL HALIDE LIGHT	
3	200 WATT METAL HALIDE LIGHT	
4	250 WATT METAL HALIDE LIGHT	
5	300 WATT METAL HALIDE LIGHT	
6	350 WATT METAL HALIDE LIGHT	
7	400 WATT METAL HALIDE LIGHT	
8	450 WATT METAL HALIDE LIGHT	
9	500 WATT METAL HALIDE LIGHT	
10	550 WATT METAL HALIDE LIGHT	
11	600 WATT METAL HALIDE LIGHT	
12	650 WATT METAL HALIDE LIGHT	
13	700 WATT METAL HALIDE LIGHT	
14	750 WATT METAL HALIDE LIGHT	
15	800 WATT METAL HALIDE LIGHT	
16	850 WATT METAL HALIDE LIGHT	
17	900 WATT METAL HALIDE LIGHT	
18	950 WATT METAL HALIDE LIGHT	
19	1000 WATT METAL HALIDE LIGHT	

POWER & COMMUNICATION SYMBOL SCHEDULE	
SYMBOL	DESCRIPTION
1	100 WATT METAL HALIDE LIGHT
2	150 WATT METAL HALIDE LIGHT
3	200 WATT METAL HALIDE LIGHT
4	250 WATT METAL HALIDE LIGHT
5	300 WATT METAL HALIDE LIGHT
6	350 WATT METAL HALIDE LIGHT
7	400 WATT METAL HALIDE LIGHT
8	450 WATT METAL HALIDE LIGHT
9	500 WATT METAL HALIDE LIGHT
10	550 WATT METAL HALIDE LIGHT
11	600 WATT METAL HALIDE LIGHT
12	650 WATT METAL HALIDE LIGHT
13	700 WATT METAL HALIDE LIGHT
14	750 WATT METAL HALIDE LIGHT
15	800 WATT METAL HALIDE LIGHT
16	850 WATT METAL HALIDE LIGHT
17	900 WATT METAL HALIDE LIGHT
18	950 WATT METAL HALIDE LIGHT
19	1000 WATT METAL HALIDE LIGHT

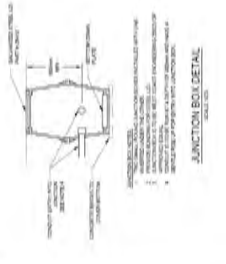
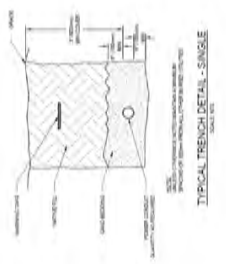
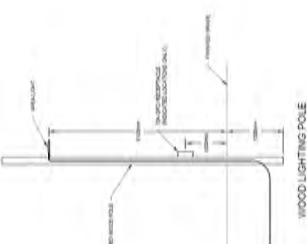

SPECIFICATIONS

<p>McElhanney 1000 West 10th Street Vancouver, BC V6H 2G6 Tel: 604-275-1234 Fax: 604-275-1235</p>	<p>PRELIMINARY NOT FOR CONSTRUCTION</p>	<p>DAVID DOUGLAS BOTANICAL GARDEN EXPANSION CONCEPT OPTION 8 ELECTRICAL SITE PLAN</p>	<p>Sheet No. E-101</p>
	<p>DATE: 10/15/2010</p>	<p>PROJECT NO.: 2010-1038-05</p>	<p>SCALE: 1/8" = 1'-0"</p>

Appendix E: Investments in Compost Demonstration Garden and Office Building (1950 Gorse Street)

1994	COST		
	(no records available)	building the garden	pathways
Garden Construction		fencing	raised beds x 5
		irrigation system	soil for beds
		plants	perimeter beds
		construction garden office	

1995- 2011			
	(no records available)	plants	
Garden Operations		maintenance	
		gravel (pathways)	
		greenhouse	
		shed	

2011 - 2021			
Garden Operations	\$28,672.55	plants	
		maintenance	
		gravel (pathways)	
		security lighting	
Occupancy City Bdlg.	\$68,942.27	alarm system	painting - inside
		repairs	painting - outside
		new roof	light fixtures - inside
		2 new toilets	light fixtures - outside
		2 new sinks	security cameras
		2 new taps	radon removal system
		new flooring	4 new baseboard heaters

Appendix F: Previous Correspondence



Mailing Address:
PO Box 444
Prince George, BC
V2N 2E3
Canada

Physical Address:
1950 Gorse Street
Prince George, BC
V2L 1G6
Canada

phone:
(250)561-7327

fax:
(250)561-7324

email:
garden@reaps.org

web: www.reaps.org

6 September 2019

Ian Wells, Manager
Real Estate, City of Prince George
1100 Patricia Boulevard
Prince George, BC V2L 3V9
CANADA

Dear Mr. Wells:

Recently it has been brought to our attention that the City has begun discussions with the Iheidli t'enneh regarding the property backing on to Iheidli t'enneh memorial park at 1950 Gorse Street to build a resource facility.

Currently, through an arrangement with the City of Prince George we lease the old Parks lunchroom for the past decade and for 25 years run the REAPS Compost Demonstration Garden which resides in the park.

As a charitable nonprofit society we would respectfully request to be involved in discussions and be kept informed.

If you have any questions, please feel free to contact myself at address below.

Sincerely,

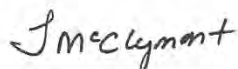

Terri McClymont
Executive Director, REAPS
PO Box 444
Prince George, BC
V2L 4S6
250-561-7327
terri.mcclymont@reaps.org



Mailing Address:
PO Box 444
Prince George, BC
V2N 2E3
Canada

Physical Address:
1950 Gorse Street
Prince George, BC
V2L 1G6
Canada

phone:
(250)561-7327

fax:
(250)561-7324

email:
garden@reaps.org

web: www.reaps.org

Deanna Wasnik,
Director, Planning & Development
City of Prince George
1100 Patricia Blvd, Prince George, B.C. V2L 3V9

8 December 2021

Dear Ms. Wasnik:

At our November 26th meeting with you at City Hall, we were pleased to have some concrete options to consider as potential sites for relocation of our demonstration garden and/or office space.

In order to make any relocation successful, there are several specific details which will need attention in order that REAPS can continue to deliver its educational services to the community, within the constraints of its funding and volunteer resources. In an effort to ensure that the both the City and REAPS have a clear picture of expectations and to ensure that nothing is overlooked, we have developed a list of those details and have included it below. We would like to ask you to have a look at the list and provide commitments that the City of PG will be able to undertake regarding these items.

The following list consists of services and materials needed to replicate, in a timely way, the infrastructure that currently supports our programming, listed in approximate order of priority and operational sequencing:

1. rental agreement for land in Lheidli T'enneh Memorial Park to provide sites for our demonstration garden and office space;
2. archaeological assessment to identify any constraints on subsurface disturbance;
3. services of a landscape architect / designer to develop a site plan;
4. access construction (i.e. driveway and/or parking area to facilitate safe public access and deliveries to the new location);
5. obtaining and installing a trailer or other substitute structure to provide office quarters;
6. utility connections (water, electrical, phone/internet, sewer);
7. moving and reinstalling structures (storage shed, greenhouse, old small garden office);
8. lumber and labour for moving and installation of raised garden beds;
9. soil and compost for garden beds;
10. labour for relocation of plants;
11. installation of irrigation system;
12. paved pathways for entrance to garden and office structure;
13. perimeter fencing comparable to that which currently surrounds the demonstration garden and office;
14. replacement / re-installation / connection of security systems currently in place at the existing garden and office location.

We emphasize that the preceding would merely replicate the infrastructure which has been in place at our existing location, and which was built up incrementally over almost three decades using volunteer and donated labour, and funding from public and private sources.

We would be pleased to discuss any aspect of this list with you in order to refine the specific commitments that the City will provide to ensure the success of this project.

Sincerely,

James Spankie, President

cc: Brenda Sieben,
Walter Babicz



Mailing Address:
PO Box 444
Prince George, BC
V2N 2E3
Canada

Physical Address:
1950 Gorse Street
Prince George, BC
V2L 1G6
Canada

phone:
(250)561-7327

fax:
(250)561-7324

email:
garden@reaps.org

web: www.reaps.org

Deanna Wasnik,
Director, Planning & Development
City of Prince George
1100 Patricia Blvd, Prince George, B.C. V2L 3V9

16 June 2022

Dear Ms. Wasnik:

At our November 26th potential sites for relocation of our demonstration garden and/or office space was brought forward. In our December 2022 letter we outlined a number of items that must be addressed for the relocation to be successful.

We asked that you review the list and provide commitments as to what the City is willing to undertake. We have yet to receive confirmation or discussion on potential City owned locations.

Since then we have been approached by the David Douglas Botanical Garden Society to join them in their new Garden expansion.

We would like to confirm the City of PG's contributions to this relocation and what the City is able to undertake.

The following list consists of services and materials needed to replicate, in a timely way, the infrastructure that currently supports our programming, listed in approximate order of priority and operational sequencing:

- 1/ grade and level entrance of road to site
- 2/ flatten, level the plateau
- 3/ installation of water and hydro and attach to building 0.25 acre

The estimated cost for the above is (\$125,000 to \$175,000).

- 3/ move existing 4 buildings to location (still working on obtaining quotes)
- 4/ office space in the visitor centre (\$77,000)

We emphasize that the preceding would merely replicate the infrastructure which has been in place at our existing location, and which was built up incrementally over almost three decades using volunteer and donated labour, and funding from public and private sources.

We would be pleased to discuss any aspect of this list with you in order to refine the specific commitments that the City will provide to ensure the success of this project.

Sincerely,

James Spankie, President

cc: Brenda Sieben,
Walter Babicz

24 August 2022



Mailing Address:
PO Box 444
Prince George, BC
V2N 2E3
Canada

Physical Address:
Suite 101, 1595 5th Ave
Prince George, BC
V2L 3L9
Canada

phone:
(250)561-7327

fax:
(250)561-7324

email:
garden@reaps.org

web: www.reaps.org

Walter Babicz
City Manager
City of Prince George

Dear Mr. Babicz,

We are writing to request your direct and timely involvement in helping our organization achieve a satisfactory relocation and rebuilding of its infrastructure – office space, educational garden, storage facilities – which REAPS has until recently operated on leased land at Leidli T’enneh Memorial Park for almost three decades.

We find ourselves in a plight which threatens our viability as an effective presence in our community – and which we did not create.

Before getting into the specifics of our circumstances and how the City can help us salvage this situation, we want to emphasize two key points:

1. We have consistently, both in public and private, stated our support for the proposed daycare in Lheidli T’enneh Memorial Park. This facility would help meet an urgent community need, and we can see potential synergies with the educational programs which are our central focus.
2. Throughout the entire history of our operations in the Park, we have enjoyed excellent practical support and day-to-day cooperation with the City’s parks staff. Any criticisms expressed here do not pertain to that portion of the City administration.

We also must stress, reluctantly, that our situation has been made worse by the manner in which our file has been handled by the Planning and Development Department. Although you will probably be told otherwise, we were blindsided by decisions affecting our future which were made without our timely involvement. It was only long after the City agreed to relinquish the portion of the Park on which we’d operated for more than 25 years that Planning and Development staff actually made a site visit to see our facilities. Critical discussions with the Regional District – our principal long-term funder – appear to have occurred without our participation.

Despite these disruptive and stressful conditions, we have managed to continue our core activities over the past few months. This has only been possible because of heroic efforts by our Executive Director, a generous donation of office space by a local business, an understanding and supportive approach from Regional District staff, and the bank of goodwill that we have been able to draw on in the local community.

On the positive side, we have secured an initial agreement which would provide us with a permanent alternative site for our infrastructure in the expanded facility currently under development at UNBC by the David Douglas Botanical Garden Society (DDBGS). We have committed our entire, albeit modest, financial reserves to this transition, but significant

efforts at fundraising, logistical planning, and moving / rebuilding remain, and timelines are tight and largely out of our control.

Why do these circumstances pose an existential threat to our ability to continue serving the community?

The key to understanding our vulnerability is that we are a small organization which has limited capacity to respond when faced with the unexpected need to relocate and rebuild our facilities – while still delivering the services that we are contractually obliged to provide through agreements with our funders, principally the Regional District.

These obligations can't just be dropped to concentrate on proposal-writing, fund-raising, logistical planning, and the physical activities of moving – repeatedly – between multiple temporary locations until our permanent site is complete.

To be clear, we remain primarily responsible for making this relocation and rebuilding effort successful. But since the City's handling of our situation has exacerbated our difficulties, we expect a serious and timely contribution to making this transition succeed.

Through our discussions with DDBGS and quotations obtained both by them and ourselves, we estimate that the final cost of the entire relocation and rebuilding project will come to at least \$250,000. A contribution of at least \$100,000 (monetary and/or in kind) would demonstrate the City's commitment to making this project successful and would be appropriate recognition of the value of REAPS' contributions to environmental quality in our city and region.

We would like to meet with you to discuss this further at the earliest possible opportunity.

Regards,

James Spankie
President

Paul Sanborn
Vice-President

Cc: Mayor Lyn Hall
City Council

Appendix G: Compost Demonstration Garden (mature)



