

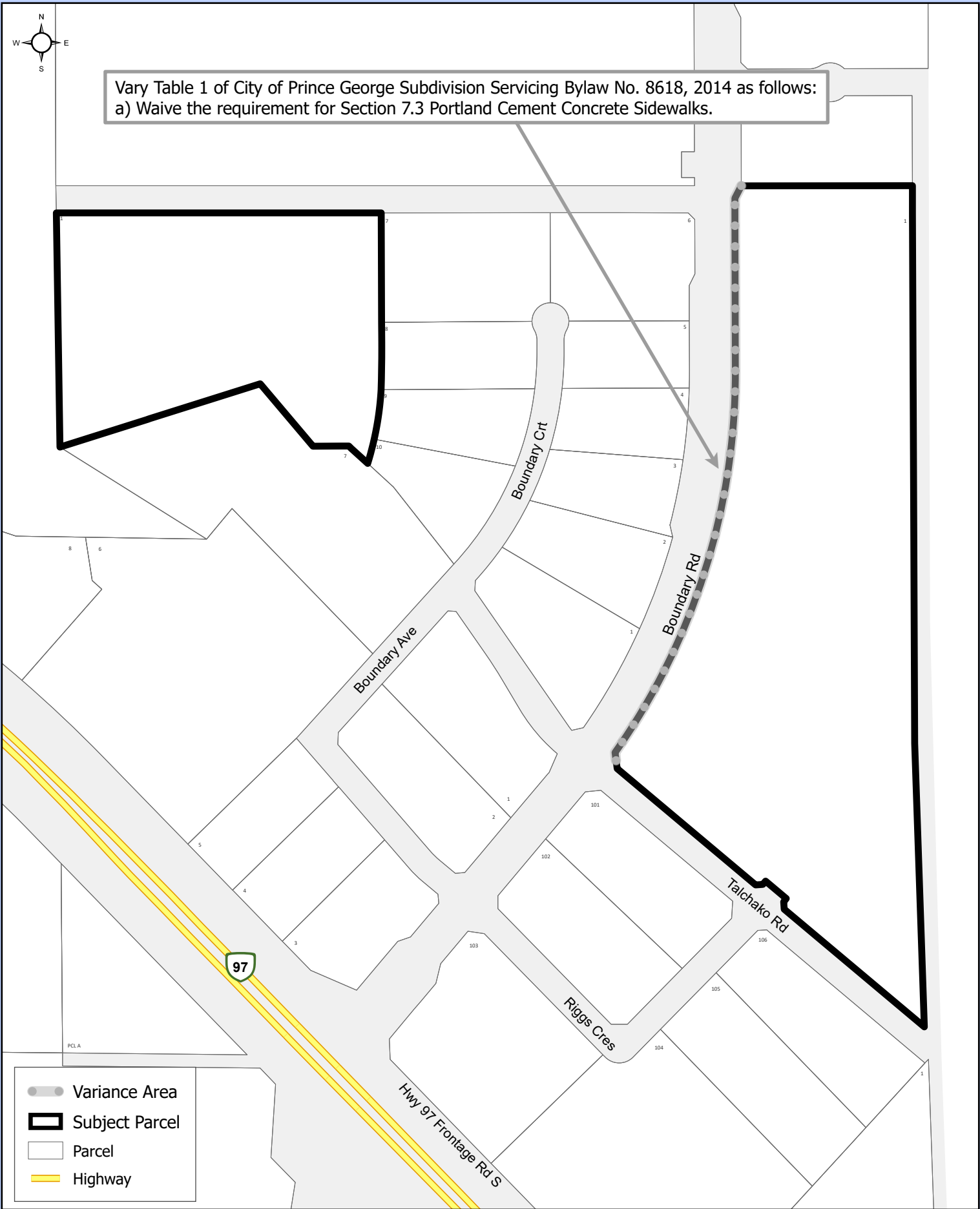



Vary Table 1 of City of Prince George Subdivision Servicing Bylaw No. 8618, 2014 as follows:  
 a) Waive the requirement for Section 7.3 Portland Cement Concrete Sidewalks.



-  Variance Area
-  Subject Parcel
-  Parcel
-  Highway

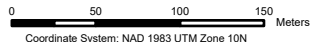

Coordinate System: NAD 1983 UTM Zone 10N  
 Projection: Transverse Mercator  
 Datum: North American 1983

1:4,500

**Exhibit "A" to VP100602**

Lot 1, DL 748, CD, Plan EPP60445 Except Plan EPP99266

